

OFFICE OF THE
DOUGLAS COUNTY SURVEYOR

Station: Y 480 .RESET T 28 S, R 5 1/2 E, Sec 21 ^{UNS}

Set By (Agency): USC & GS

Date Set: 1963

Recovered By FLI (DCSO)

Date Recovered 6-29-84

Recovered By Harry Heislein (USFS)

Date Recovered Fall 1985

Recovered By _____

Date Recovered _____

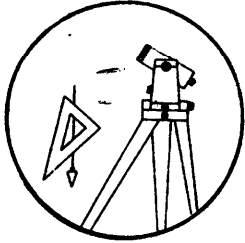

Y-008

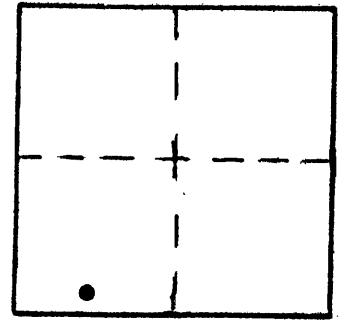

VERTICAL CONTROL NGVD 29

Elevation: 5243.513 NGS Line # 128 USGS Line # _____ OSHD Line # _____

Precision: 2nd Agency: USC & GS Proj. # 2004-8 CS57/23 Date: 1963

HORIZONTAL CONTROL

South Zone State Plane Coordinates: Y(Northing) _____ X(Easting) _____

Precision: _____ Agency: _____ Proj. # _____ Date: _____

Approximate Geographic Position: Latitude 43° 01' 24" Longitude 122° 08' 05"

DESCRIPTION and TO REACH

SKETCH

S.W. of the intersection
of new Hwy 230 and old
Hwy 138.

B.C. in concrete post
0.1 ft. above ground,
4 ft. lower than pavement.

Monument lies 125 ft. right (south) of
station 1247+30.

Shown on USGS Quads: Diamond Lake 15'
Diamond Lake 7 1/2'

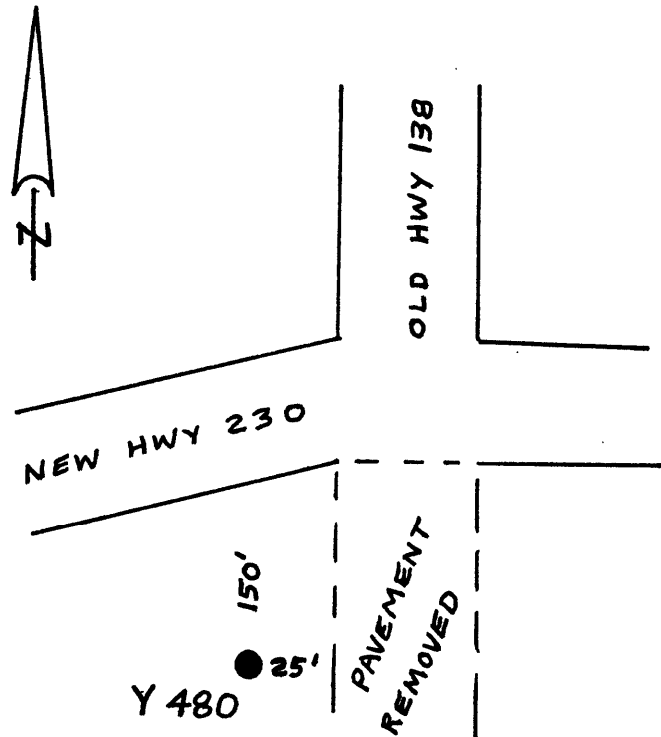

Reference Marks:

Note: For further information, contact the Douglas County Surveyor's Office, Room 205 Douglas County Justice Building, Roseburg, OR 97470. Phone 440-4278. Douglas County residents outside the Roseburg calling area, dial toll free 1-800-452-0991.