

OFFICE OF THE
DOUGLAS COUNTY SURVEYOR

Station: Y 477
Set By (Agency): USC&GS
Date Set: 1941
Recovered By RWS, SJF
Date Recovered 10/7/87
Recovered By _____
Date Recovered _____
Recovered By _____
Date Recovered _____

T 27 S, R 3 E, Sec 11



Y-007

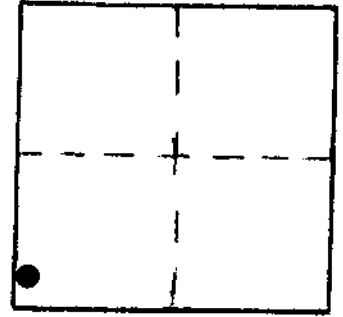

VERTICAL CONTROL NGVD 29

Elevation: 3127.487 NGS Line # 94 USGS Line # _____ OSHD Line # _____
Precision: 1st Agency: USC&GS Proj. # _____ Date: 1961

HORIZONTAL CONTROL

South Zone State Plane Coordinates: Y(Northing) _____ X(Easting) _____
Precision: _____ Agency: _____ Proj. # _____ Date: _____
Approximate Geographic Position: Latitude _____ Longitude _____

DESCRIPTION and TO REACH

A USC&GS disk stamped "Y 477 1941"
set in a 8 1/2 in. square concrete
post protruding 3 in. above ground.

TO REACH:

From the intersection of USFS Rd. #37
(Watson Falls Rd.) and USFS Rd. #3701
(Big Camas Rd.) in T27S, R4E, Sec. 7,
proceed westerly along USFS Rd. #3701
approx. 2.3 miles to monument on left.
Monument is easterly of the intersection
of USFS Rd. #3701 and USFS spur Rd. #220
along USFS Rd. #3701 approx. 120 ft. on
right.

SKETCH

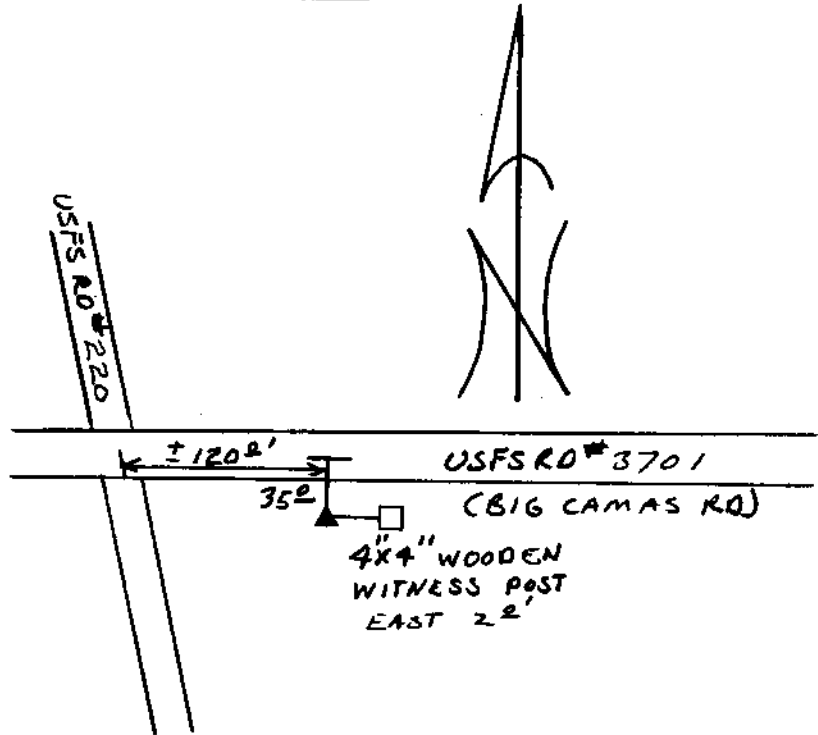

Reference Marks:

Note: For further information, contact the Douglas County Surveyor's Office, Room 205
Douglas County Justice Building, Roseburg, OR 97470. Phone 440-4278. Douglas
County residents outside the Roseburg calling area, dial toll free 1-800-452-0991.