

OFFICE OF THE  
DOUGLAS COUNTY SURVEYOR

Station: X 739

T25S R5W Sec. 17

Date Set: 1987

Set By (Agency): NGS

DCSO Designation: X-056

Date Recovered: 8-93

Recovered By: \_\_\_\_\_

Date Recovered: \_\_\_\_\_

Recovered By: \_\_\_\_\_

Date Recovered: \_\_\_\_\_

Recovered By: \_\_\_\_\_

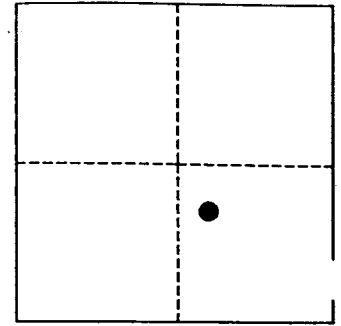
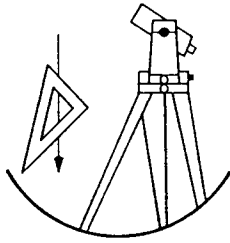

VERTICAL CONTROL

~~NAVD 88~~ Elevation: 544.580 FEET      NAVD 88 Elevation: 165.988 METERS

NGS Line # 125035      USGS LINE # \_\_\_\_\_      OSHD Line # \_\_\_\_\_      FILE # \_\_\_\_\_

Precision: 1ST ORDER      Agency: NGS      Proj: \_\_\_\_\_      Date: 1988

HORIZONTAL CONTROL

O.C.S. 27      Y(Northing): \_\_\_\_\_      O.C.S. 83      Y(Northing): 642436

(South Zone)      X(Easting): \_\_\_\_\_      (South Zone)      X(Easting): 4173212

Precision: GIS SCALED      Agency: DCSO      Proj: \_\_\_\_\_      Date: 2014

Approx. O.C.S. 27 Geographic Position:      Latitude: 43°23'42"      Longitude: 123°18'50"

Approx. O.C.S. 83 Geographic Position:      Latitude: \_\_\_\_\_      Longitude: \_\_\_\_\_

Found: A 9/16 inch diameter stainless steel rod set under a 6 - 5/8 inch diameter aluminum collar and access cover set in a concrete and flush with ground. Collar is stamped "X 739 1987".

To reach: Monument is at the southwest corner of Sixth Ave. and State St. (also Old Hwy 99) in Sutherlin, Oregon in T25S R5W Sec17.

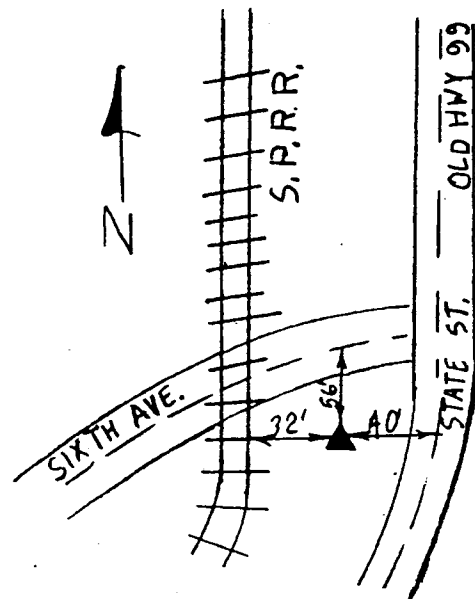

Note: For further information contact the Douglas County Surveyors Office, Room 205 Douglas County Justice Building, Roseburg, OR 97470. Phone 440-4272. Douglas County Residents outside Roseburg calling area, dial toll free 1-800-477-0991.