

OFFICE OF THE
DOUGLAS COUNTY SURVEYOR

Station: X-052

T 29 S, R 5 W, Sec 25

Date Set: 1992

Set By (Agency): DCSO

DCSO Designation: X-052

Date Recovered: 7/92

Recovered By: TF HS

Date Recovered: _____

Recovered By: _____

Date Recovered: _____

Recovered By: _____

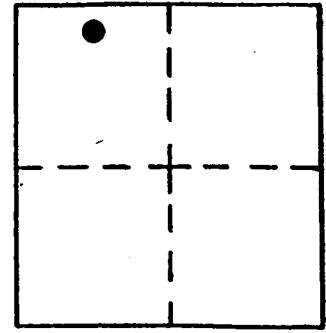
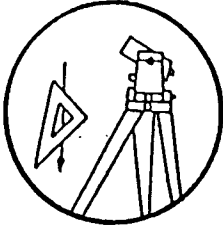

VERTICAL CONTROL CORPSCON6 NAVDB8 737.119 FT.

Elevation: 733.713 NGS Line # _____ USGS Line # _____ OSHD Line # _____

Precision: 2ND ORDER Agency: DCSO Proj. # 2007 CS66/47 Date: 1992

HORIZONTAL CONTROL

O.C.S. 27 Y(Northing): _____

O.C.S. 83 Y(Northing): 507509

South Zone X(Easting): _____

South Zone X(Easting): 4187944

Precision: G/S SCALED Agency: DCSO Proj. # _____ Date: 2014

Approx. NAD ~~83~~ Geographic Position: Latitude 43°01'35" Longitude 123°14'30"
Scaled 27

Set: A standard DCSO disk stamped "X-052 1992"
set in a 6" x 36" corrugated sewer pipe protruding
2" from the ground and filled with concrete.

To reach: From the intersection of South Myrtle
Rd. (Co.Rd.#18) and Riverside Dr. (Co.Rd.#18A) in
T29S R5W sec. 23, continue on South Myrtle Rd. easterly
0.55mi. to mon. on the left.

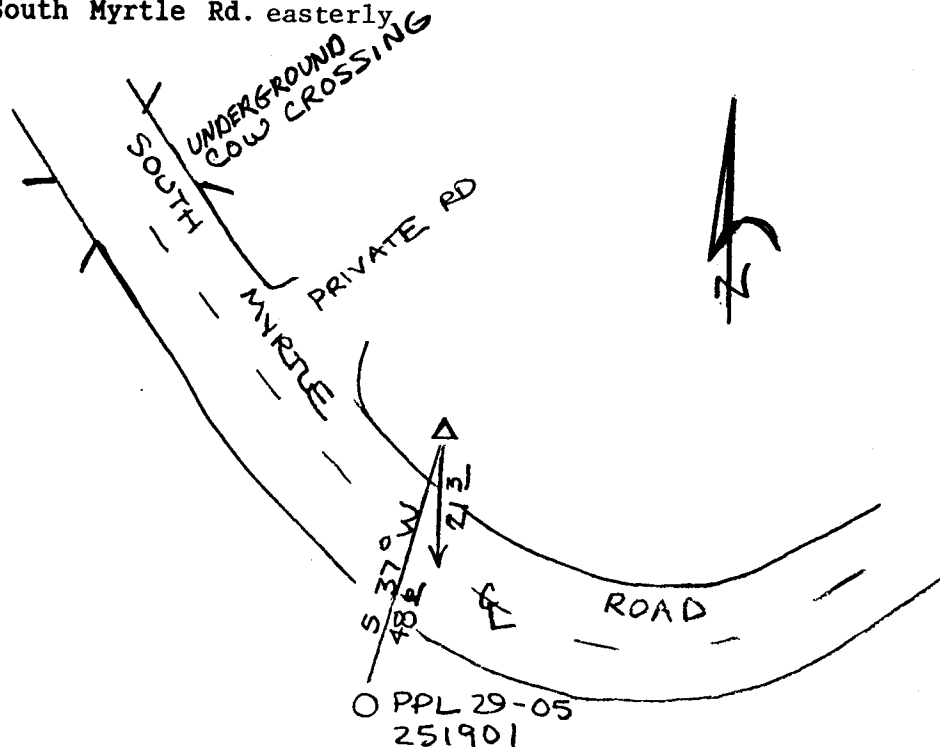

Note: For possible further information contact the Douglas County Surveyors Office,
Room 205 Douglas County Justice Building, Roseburg, OR 97470. Phone 440-4272.
Douglas County residents outside the Roseburg calling area, dial toll free
1-800-477-0991.