

OFFICE OF THE
DOUGLAS COUNTY SURVEYOR

Station: X-047

T 29 S, R 4 W, Sec 21

Date Set: 1992

Set By (Agency): DCSO

DCSO Designation: X-047

Date Recovered: 6\11\92

Recovered By: TF HS

Date Recovered: 12/28/92 RWS, SJF

Recovered By: _____

Date Recovered: _____

Recovered By: _____

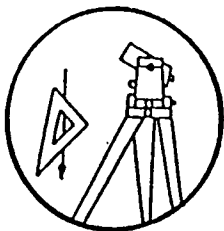
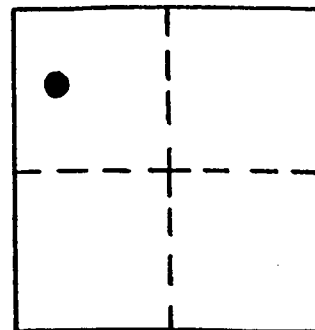

VERTICAL CONTROL CORPSCON6 NAVD88 833.096 FT.

Elevation: 829.697 NGS Line # _____ USGS Line # _____ OSHD Line # _____

Precision: 2ND ORDER Agency: DCSO Proj. # 2007 Date: 1992

HORIZONTAL CONTROL

O.C.S. 27 Y(Northing): _____ O.C.S. 83 Y(Northing): 511029

South Zone X(Easting): _____ South Zone X(Easting): 4203174

Precision: SCALED Agency: DCSO Proj. # _____ Date: 2014

Approx. NAD 83 Geographic Position: Latitude 43° 02' 14" Longitude 123° 11' 04"

Set: A standard DCSO disk stamped "X-047 1992"
set in a 3' x 4' boulder 2.4 ft. lower than the road
surface.

Reach: From the intersection of South Myrtle Rd.
(Co.Rd.#18) and Riverside Dr. (Co.Rd.#18A) in T29S
R5W sec. 23, continue on South Myrtle Rd. to MP
6.25 and mon. on the right.

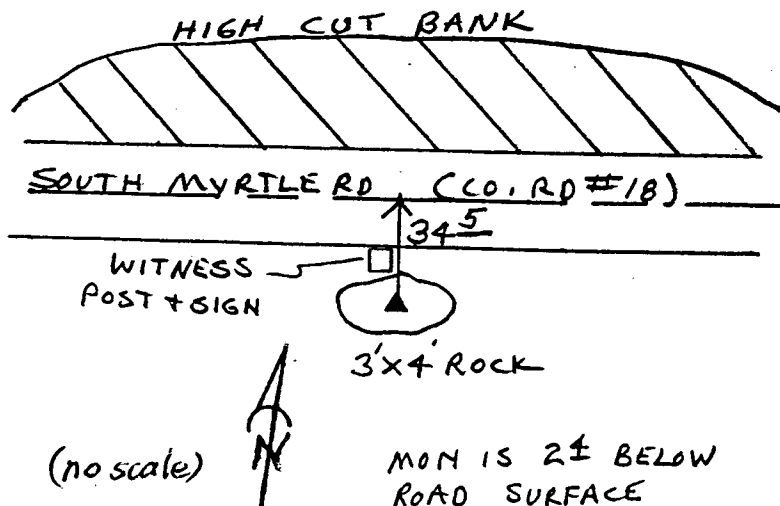

Note: For possible further information contact the Douglas County Surveyors Office,
Room 205 Douglas County Justice Building, Roseburg, OR 97470. Phone 440-4272.
Douglas County residents outside the Roseburg calling area, dial toll free
1-800-477-0991.