

OFFICE OF THE
DOUGLAS COUNTY SURVEYOR

Station: X-032

T 27 S, R 2W , Sec 9

Date Set: 1992

Set By (Agency): DCSO

Date Recovered: 3/9/92

Recovered By: RWS-SJF 10/1999

Date Recovered: _____

Recovered By: _____

Date Recovered: _____

Recovered By: _____

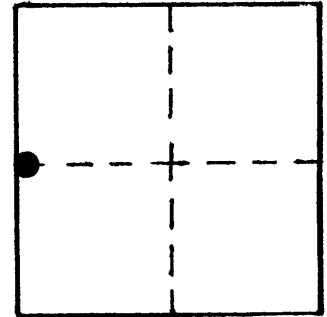

X-032 27S 2W 9
X-032

NAD 581358.61 4268131.60
83 43°14' 8" 122°57' 5"

VERTICAL CONTROL NGVD 29

Elevation: ~~1060.0~~ 1060.61 NGS Line # _____ USGS Line # _____ OSHD Line # _____

Precision: ~~GPS~~ 3rd Agency: DCSO Proj. # 2000 2007 Date: 1992 1999

CS 66/56

HORIZONTAL CONTROL

South Zone O.C.S. 27: Y(Northing) 581,395.16 X(Easting) 1,347,171.83

South Zone O.C.S. 83: Y(Northing) _____ X(Easting) _____

Precision: 1/25,000 Agency: DCSO Proj. # 2008 Date: 1992

Approx. ~~NAD 83~~ Geographic Position: Latitude 43° 14' 08.0" Longitude 122° 57' 00.7"

DESCRIPTION and TO REACH

SKETCH

Set: A standard DCSO disk stamped "X-032 1992"
set in a concrete driveway.

To Reach: From the intersection of Buckhorn Rd. and
Litter River Rd. proceed N'Easterly 9.85 mi.
(MP 21.35) to intersection with drive to Job
Corp housing which is the 1st. Rd. (approx. 150 ±)
to the left beyond arched green metal bridge at
Wolf Creek Trailhead. See sketch.

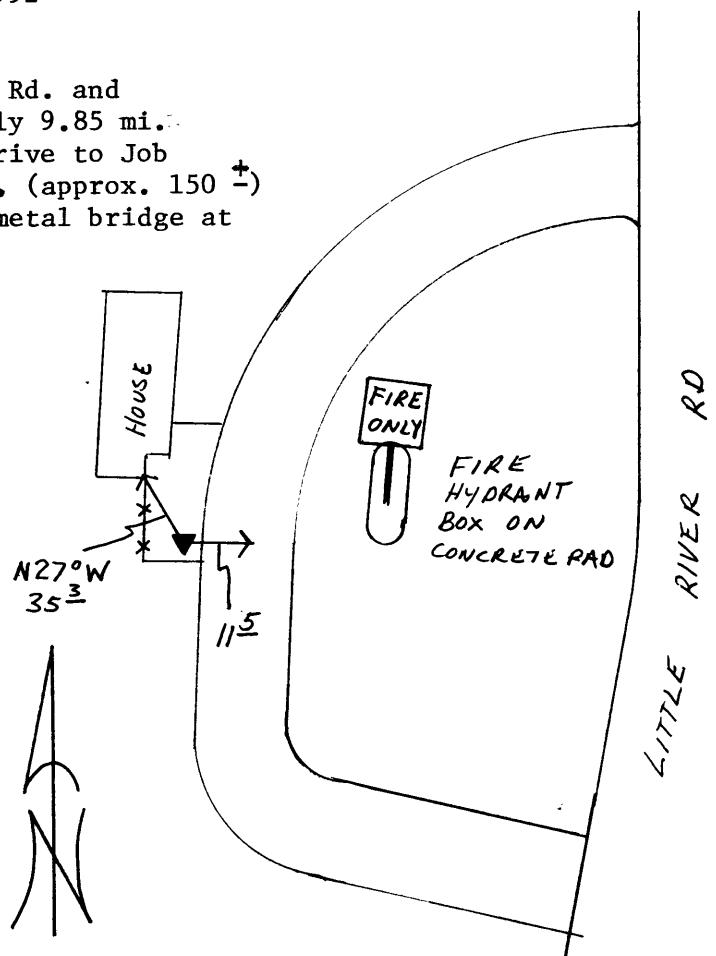

Reference Marks:

Note: For further information, contact the Douglas County Surveyor's Office, Room 205
Douglas County Justice Building, Roseburg, OR 97470. Phone 440-4278. Douglas
County residents outside the Roseburg calling area, dial toll free 1-800-452-0991.