

OFFICE OF THE  
DOUGLAS COUNTY SURVEYOR

Station: X-026

T 32 S, R 8W, Sec 1

Date Set: 1991

Set By (Agency): DCSO

Date Recovered: 9-13-91

Recovered By: RWS, SJF

Date Recovered: \_\_\_\_\_

Recovered By: \_\_\_\_\_

Date Recovered: \_\_\_\_\_

Recovered By: \_\_\_\_\_

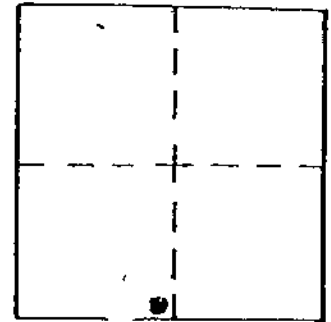

X-026  
X-026

32S 8W 1

NAD 432614.25 4090732.83  
83 42°48'42" 123°35'46"

VERTICAL CONTROL

Elevation: 1033.097 NGS Line # \_\_\_\_\_ USGS Line # \_\_\_\_\_ OSHD Line # \_\_\_\_\_

Precision: 2nd order Agency: DCSO Proj. # 2020 Date: 1993

HORIZONTAL CONTROL

South Zone O.C.S. 27: Y(Northing) 432,649.69 X(Easting) 1,169,774.30

South Zone O.C.S. 83: Y(Northing) \_\_\_\_\_ X(Easting) \_\_\_\_\_

Precision: 1/25,000 Agency: DCSO Proj. # GPS 27/83 Date: 1991

Approx. NAD 83 Geographic Position: Latitude 42° 48' 42" Longitude 123° 35' 41"

DESCRIPTION and TO REACH

SKETCH

Set: A DCSO disk stamped "X-026 1991" set in southwest corner of concrete bridge.

To reach: At the intersection of Cow Creek Rd. (Co. Rd. #321) and BLM Rd. 32-8-1.0 (Middle Fork of Cow Crk.) monument is at southwest corner of concrete bridge over Cow Creek, in T32S, R8W sec. 1.

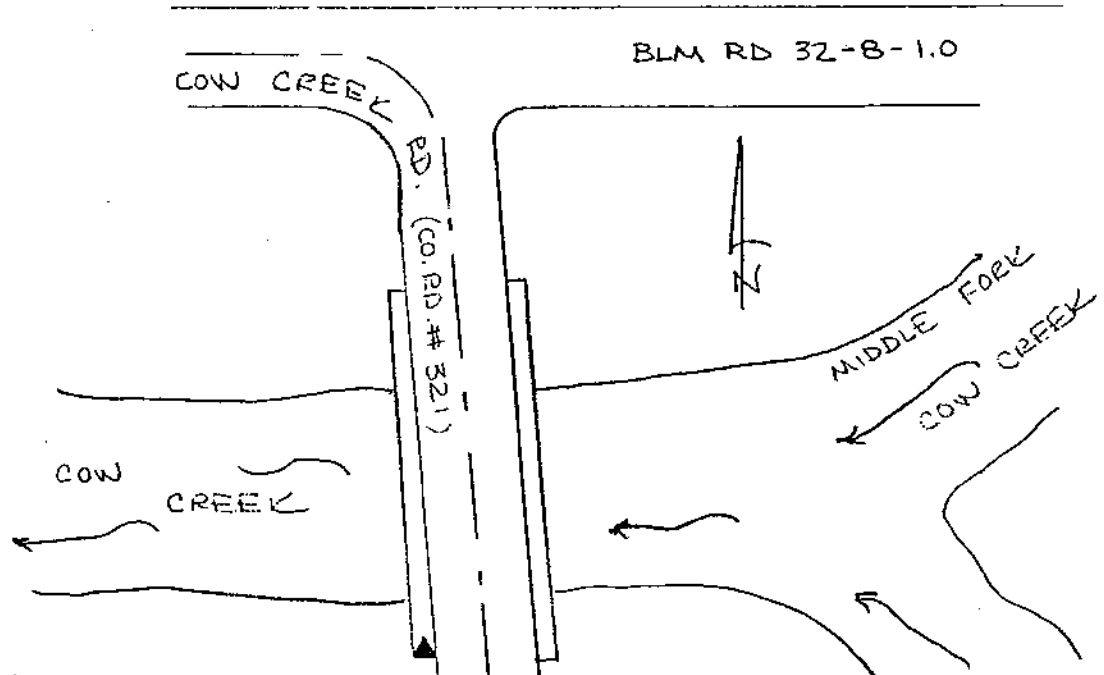

Reference Marks:

Note: For further information, contact the Douglas County Surveyor's Office, Room 205 Douglas County Justice Building, Roseburg, OR 97470. Phone 440-4278. Douglas County residents outside the Roseburg calling area dial toll free 1 800 452 0091