

DOUGLAS COUNTY SURVEYOR

Set By (Agency): 1963

X-019

Date Set: USC&GS

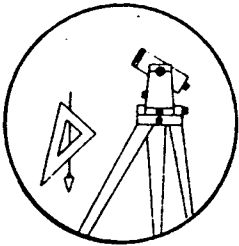

Recovered By RS, PB

Date Recovered 11/16/83

Recovered By \_\_\_\_\_

Date Recovered \_\_\_\_\_

Recovered By \_\_\_\_\_

Date Recovered \_\_\_\_\_

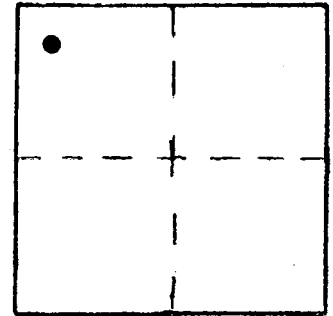

VERTICAL CONTROL CORPSCON6 NAVD88 497.805 FT.

Elevation: 494.340 NGS Line # 27 USGS Line # \_\_\_\_\_ OSHD Line # \_\_\_\_\_

Precision: 2nd Agency: USC&GS Proj. # \_\_\_\_\_ Date: 1963

HORIZONTAL CONTROL

South Zone State Plane Coordinates: Y(Northing) 490932 X(Easting) 4032823

Precision: GIS SCALED Agency: DCSO Proj. # \_\_\_\_\_ Date: 2014

Approximate Geographic Position: Latitude \_\_\_\_\_ Longitude \_\_\_\_\_

DESCRIPTION and TO REACH

SKETCH

DESCRIPTION:

A disk stamped "X 76 RESET 1963" set flush on a boulder.

TO REACH:

From the intersection of State Hwy.42 and Slater Cr. Rd. in T30S,R9W,Sec.17; proceed westerly along State Hwy.42 1.25 miles to monument on right.

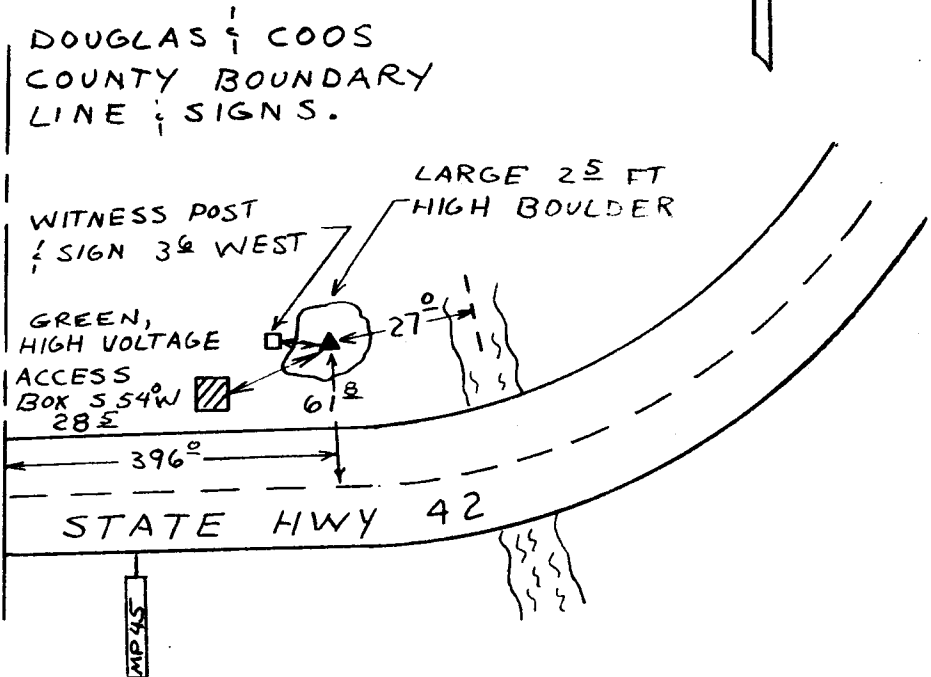

Reference Marks:

Note: For further information, contact the Douglas County Surveyor's Office, Room 205 Douglas County Justice Building, Roseburg, OR 97470. Phone 440-4278. Douglas County residents outside the Roseburg calling area, dial toll free 1-800-452-0991.