

OFFICE OF THE  
DOUGLAS COUNTY SURVEYOR

Station: X 552 T 30 S, R 6 W , Sec 23  
 Set By (Agency): USC&GS  
 Date Set: 1954  
 Recovered By RWS,SJF  
 Date Recovered Nov. 7,1988  
 Recovered By \_\_\_\_\_  
 Date Recovered \_\_\_\_\_  
 Recovered By \_\_\_\_\_  
 Date Recovered \_\_\_\_\_

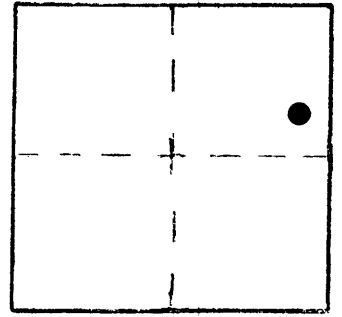
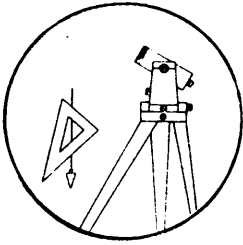

X-018

VERTICAL CONTROL NGVD 29

Elevation: 710.087 ft. NGS Line # 6 USGS Line # \_\_\_\_\_ OSHD Line # \_\_\_\_\_  
 Precision: 1st. order Agency: USC&GS Proj. # 2013 Date: 1957

HORIZONTAL CONTROL

South Zone State Plane Coordinates: Y(Northing) \_\_\_\_\_ X(Easting) \_\_\_\_\_  
 Precision: \_\_\_\_\_ Agency: \_\_\_\_\_ Proj. # \_\_\_\_\_ Date: \_\_\_\_\_  
 Approximate Geographic Position: Latitude \_\_\_\_\_ Longitude \_\_\_\_\_

DESCRIPTION and TO REACH

A 3 1/2 inch diameter USC&GS disk stamped "X 552 1954" set flush near center of top of a concrete foundation pad which formerly supported a railroad semaphore signal. Pad protrudes approximately 6 inches above ground.

From the intersection of Fifth Avenue and Main Street in Riddle, Oregon, T30S R6W, Section 24 proceed northwesterly along Main Street approximately 200 feet to monument on left, approximately 110 feet southwesterly from roadway centerline.

SKETCH

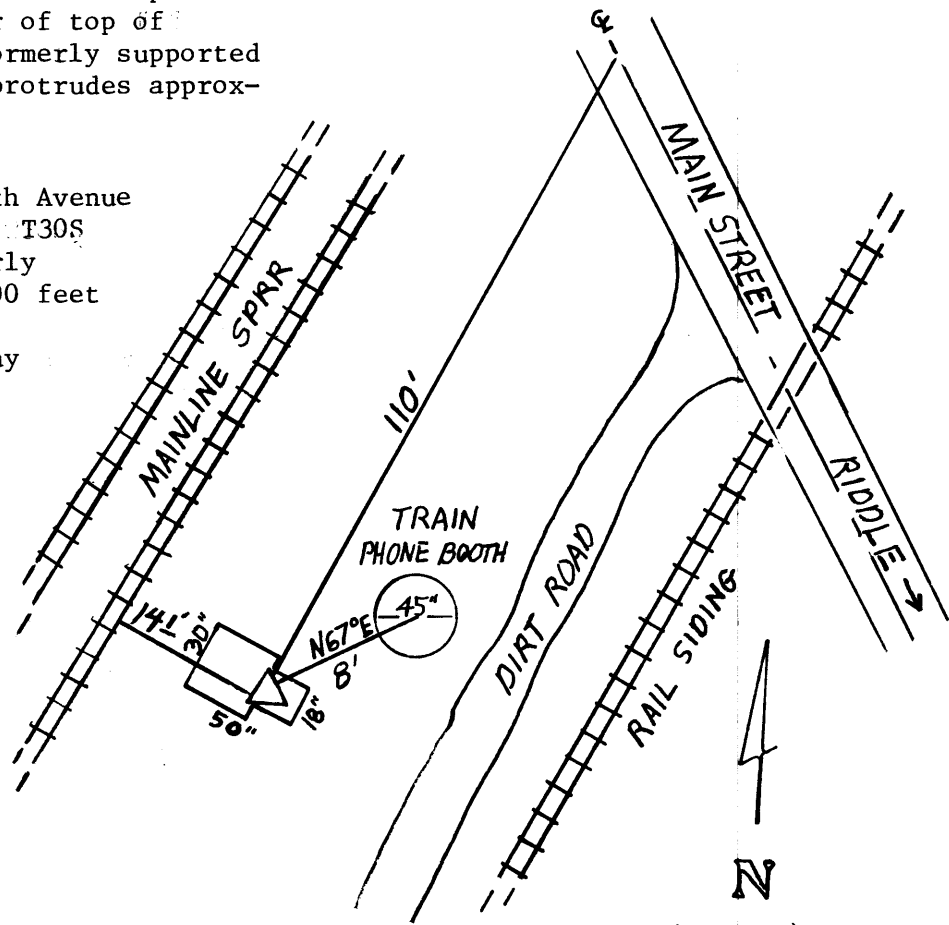

Reference Marks:

(no scale)

Note: For further information, contact the Douglas County Surveyor's Office, Room 205 Douglas County Justice Building, Roseburg, OR 97470. Phone 440-4278. Douglas County residents outside the Roseburg calling area, dial toll free 1-800-452-0991.