

Douglas County Geodetic Data Sheet

Station: WWC-1
 Date Set: 1998 Set By (Agency): DCSO
 Last Date Recovered: 12/00/2000

Designation: W-065

T 29 R 06 WS 16 D

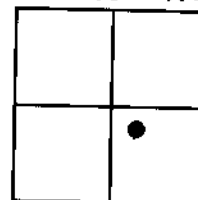

VERTICAL CONTROL

NGVD 29 Elevation: 665.45 Feet
 Precision: 3RD ORDER Agency: DCSO

CS File: 66055

Date: 1998

NAVD 88 Elevation: Meters
 Precision: Agency:

CS File:

Date:

HORIZONTAL CONTROL

OCS 27 Y(Northing): X(Easting):
 Precision: GIS Agency: DCSO

Lat 43° 02' 50.4" Long: 123° 24' 37.6"
 CS File: 66055 Date: 2000

OCS 83 Y(Northing): X(Easting):
 Precision: Agency:

Lat Long:
 CS File: Date:

OCS 83/91 Y(Northing): X(Easting):
 Precision: Agency:

Lat Long:
 CS File: Date:

OCS 83/98 Y(Northing): X(Easting):
 Precision: Agency:

Lat Long:
 CS File: Date:

Description:

Scaled Lat 43° 02' 50" Long: 123° 24' 38"

A DCSO BRASS CAP STAMPED; WWC-1 1998; SET IN AN 8 X 42 INCH CONCRETE FILLED BELL TILE; PROTRUDES 8 INCHES ABOVE GROUND.

Comments:

FROM THE INTERSECTION OF EAST WILLIS CREEK RD; CO. RD 88B; AND WEST WILLIS CREEK RD; CO. RD 88A; IN T29S R6W SEC.15; PROCEED SOUTHWESTERLY ALONG WEST WILLIS CREEK RD 0.55 MILES TO MONUMENT ON RIGHT.

Notes:

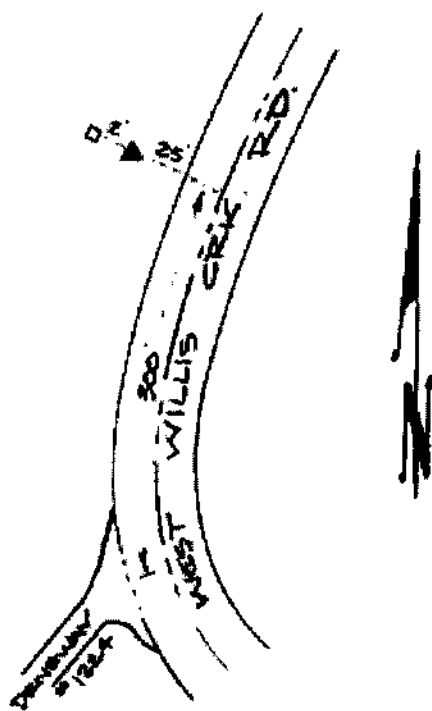

Note: For further information contact the Douglas County Surveyors Office, Room 105A Douglas County Courthouse, Roseburg, OR 97470. Phone 440-4272 or Fax (541)957-8150. Douglas County Residents outside Roseburg calling area, dial toll free 1-800-224-1619.