

Douglas County Geodetic Data Sheet

T 29 R 06 WS 09 D

Station: WC-3

Designation: W-064

Date Set: 1998 Set By (Agency): DCSO

Last Date Recovered: 12/00/2000

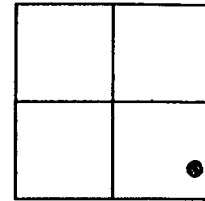

VERTICAL CONTROL

NGVD 29 Elevation: 618.83 Feet

Precision: 3RD ORDER Agency: DCSO

CS File: 66055

Date: 1998

NAVD 88 Elevation: 622.29 FT.

Precision: CORPSCON6 Agency:
NAVD88

CS File:

Date:

HORIZONTAL CONTROL

OCS 27 Y(Northing): X(Easting): Lat 43° 03' 32.3" Long: 123° 24' 13.8"

Precision: GIS Agency: DCSO CS File: 66055 Date: 2000

OCS 83 Y(Northing): 520866 X(Easting): 4145078 Lat Long:

Precision: GIS SCALED Agency: DCSO CS File: Date: 2014

OCS 83/91 Y(Northing): X(Easting): Lat Long:

Precision: Agency: CS File: Date:

OCS 83/98 Y(Northing): X(Easting): Lat Long:

Precision: Agency: CS File: Date:

Description: Scaled Lat 43° 03' 32" Long: 123° 24' 14"

A DCSO BRASS CAP STAMPED; WC-3 1998; SET IN A 8 X 42 INCH CONCRETE FILLED BELL TILE; PROTRUDES 2 IN. ABOVE GROUND.

Comments:

FROM THE INTERSECTION OF RICE CREEK RD;
CO RD NO. 43A; AND WILLIS CREEK RD; CO. RD
88; IN T29S R6W SEC. 4 - PROCEED SOUTH
EASTERLY ALONG WILLIS CREEK RD. 2.20 MILES
TO MONUMENT ON LEFT.

Notes:

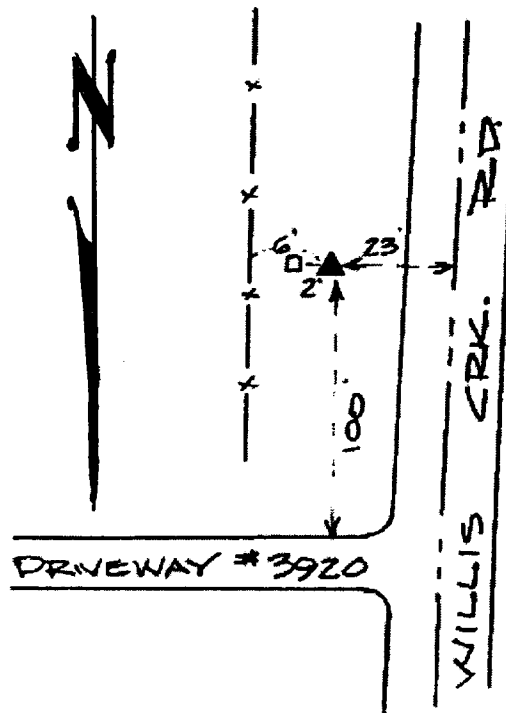

Note: For further information contact the Douglas County Surveyors Office, Room 105A Douglas County Courthouse, Roseburg, OR 97470. Phone 440-4272 or Fax (541)957-8150. Douglas County Residents outside Roseburg calling area, dial toll free 1-800-224-1619.