

OFFICE OF THE
DOUGLAS COUNTY SURVEYOR

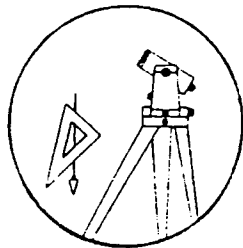

DESIG. W-054

Station: WKP 11 T 29 S, R 7 W, Sec 29
 Date Set: 1945
 Set By (Agency): USGS
 Date Recovered: 3/14/91
 Recovered By: RWS, SJF; 1999
 Date Recovered: _____
 Recovered By: _____
 Date Recovered: _____
 Recovered By: _____

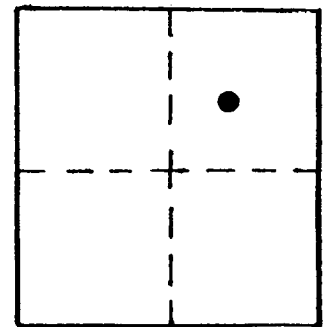

VERTICAL CONTROL CORPSCON6 NAVD88 876.42 FT.
 Elevation: 872.99 NGS Line # _____ USGS Line # _____ OSHD Line # _____
 Precision: 3rd Agency: DCSO Proj. # CS 66/50 Date: 1999
HORIZONTAL CONTROL (872.82' USGS 1945 3rd ORDER LINE # 147)
 South Zone O.C.S. 27: Y(Northing) _____ X(Easting) _____
 South Zone O.C.S. 83: Y(Northing) 509828 X(Easting) 4105949
 Precision: GIS SCALED Agency: DCSO Proj. # _____ Date: 2014
 Approx. NAD 83 Geographic Position: Latitude 43° 01' 30" Longitude 123° 32' 55"

DESCRIPTION and TO REACH

A USGSdisk stamped "WKP 11 ELEV. 872 FT. 1945"
set in a 4'X6'X2' rock.

From the intersection of Olalla Rd. (Co.Rd.#38)
and Ireland Rd. (Co.Rd.#140) in T29S,R7W,Sec.8;
proceed northwesterly along Sabrina Ln. 0.25 miles
to monument on left.

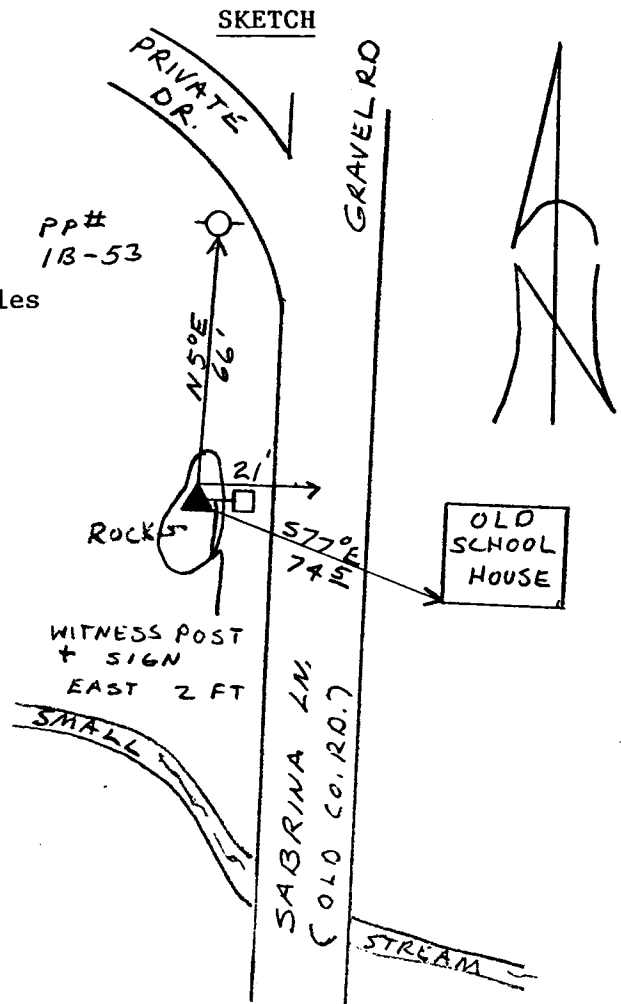

Reference Marks:

Note: For further information, contact the Douglas County Surveyor's Office, Room 205 Douglas County Justice Building, Roseburg, OR 97470. Phone 440-4278. Douglas County residents outside the Roseburg calling area, dial toll free 1-800-452-0991.