

OFFICE OF THE  
DOUGLAS COUNTY SURVEYOR

Station: Welk

T 22 S, R 7W , Sec 19

Date Set: 1989

Set By (Agency): ORDOT

Date Recovered: 7/91

Recovered By: TF

Date Recovered: \_\_\_\_\_

Recovered By: \_\_\_\_\_

Date Recovered: \_\_\_\_\_

Recovered By: \_\_\_\_\_

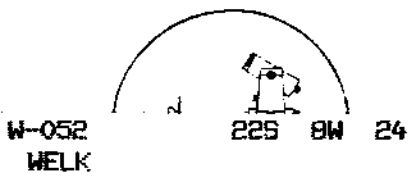
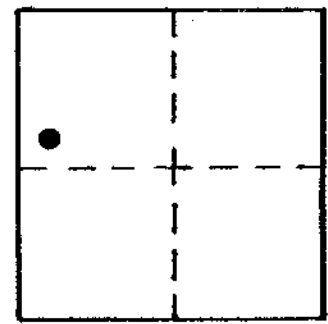

NAD 735587.31 4105505.96  
83 43°38'38" 123°34'57"

VERTICAL CONTROL

Elevation: 142.55 NGS Line # \_\_\_\_\_ USGS Line # \_\_\_\_\_ OSHD Line # \_\_\_\_\_

Precision: 3rd Order Agency: NGS Proj. # 83/91 GPS Network Date: 1991

HORIZONTAL CONTROL

South Zone O.C.S. 27: Y(Northing) 735,622.21 X(Easting) 1,184,545.70

South Zone O.C.S. 83: Y(Northing) \_\_\_\_\_ X(Easting) \_\_\_\_\_

Precision: 1/25,000 Agency: DCSO Proj. # GPS 27/83 Date: 1991

Approx. NAD 83 Geographic Position: Latitude \_\_\_\_\_ Longitude \_\_\_\_\_

DESCRIPTION and TO REACH

SKETCH

Found: A ORDOT Primary GPS disk stamped "Welk 1989" set in the top of a mass of concrete 30 cm dia. at ground surface.  
To Reach: Station is approx. 1 mi. west of Elkton along St. Hwy 38 at mi. post 35.34 on the southerly side of the road.

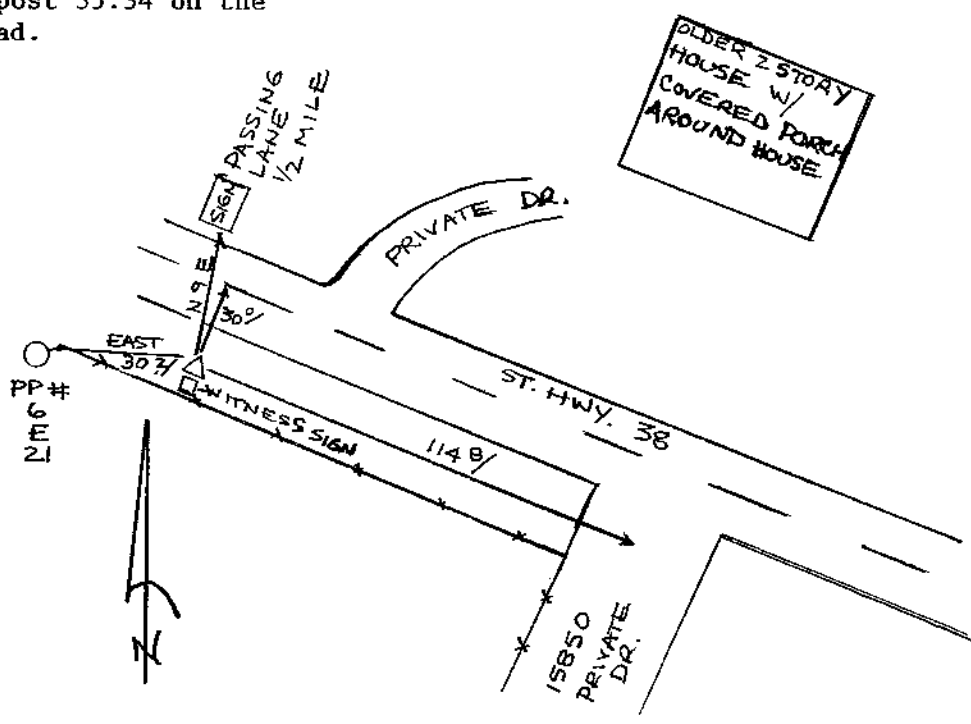

Reference Marks:

Note: For further information, contact the Douglas County Surveyor's Office, Room 205 Douglas County Justice Building, Roseburg, OR 97470. Phone 440-4278. Douglas County residents outside the Roseburg calling area, dial toll free 1-800-452-0991.