

OFFICE OF THE
DOUGLAS COUNTY SURVEYOR

Station: W 552 T 30 S, R 6 W , Sec 23
 Set By (Agency): USC&GS
 Date Set: 1954
 Recovered By RWS,SJF
 Date Recovered Nov. 7, 1988
 Recovered By _____
 Date Recovered _____
 Recovered By _____
 Date Recovered _____

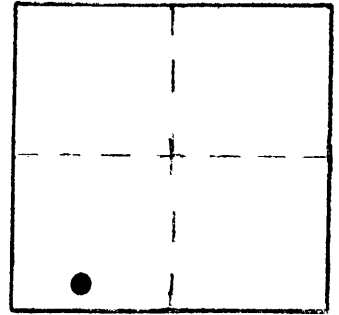
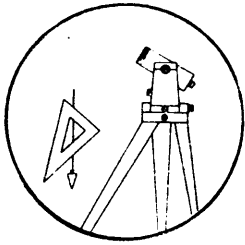

W-044

VERTICAL CONTROL NGVD 29

Elevation: 706.944 ft. NGS Line # 6 USGS Line # _____ OSHD Line # _____
 Precision: 1st. Agency: USC&GS Proj. # 2013 Date: 1957

HORIZONTAL CONTROL

South Zone State Plane Coordinates: Y(Northing) _____ X(Easting) _____
 Precision: _____ Agency: _____ Proj. # _____ Date: _____
 Approximate Geographic Position: Latitude _____ Longitude _____

DESCRIPTION and TO REACH

A 3 in. diam. USC&GS disk stamped "W 552 1954" set in the East end of an 8 1/2 ft. long by 1 1/2 ft. wide concrete headwall of a 24 in. diameter culvert.

From the intersection of Cow Creek Rd. (Co. Rd. # 39) and Riddle By-pass Rd. (Co. Rd. # 263) in T30S,R6W,Section 23 proceed south-westerly along Cow Creek Rd. approximately 0.55 miles to monument on left.

SKETCH

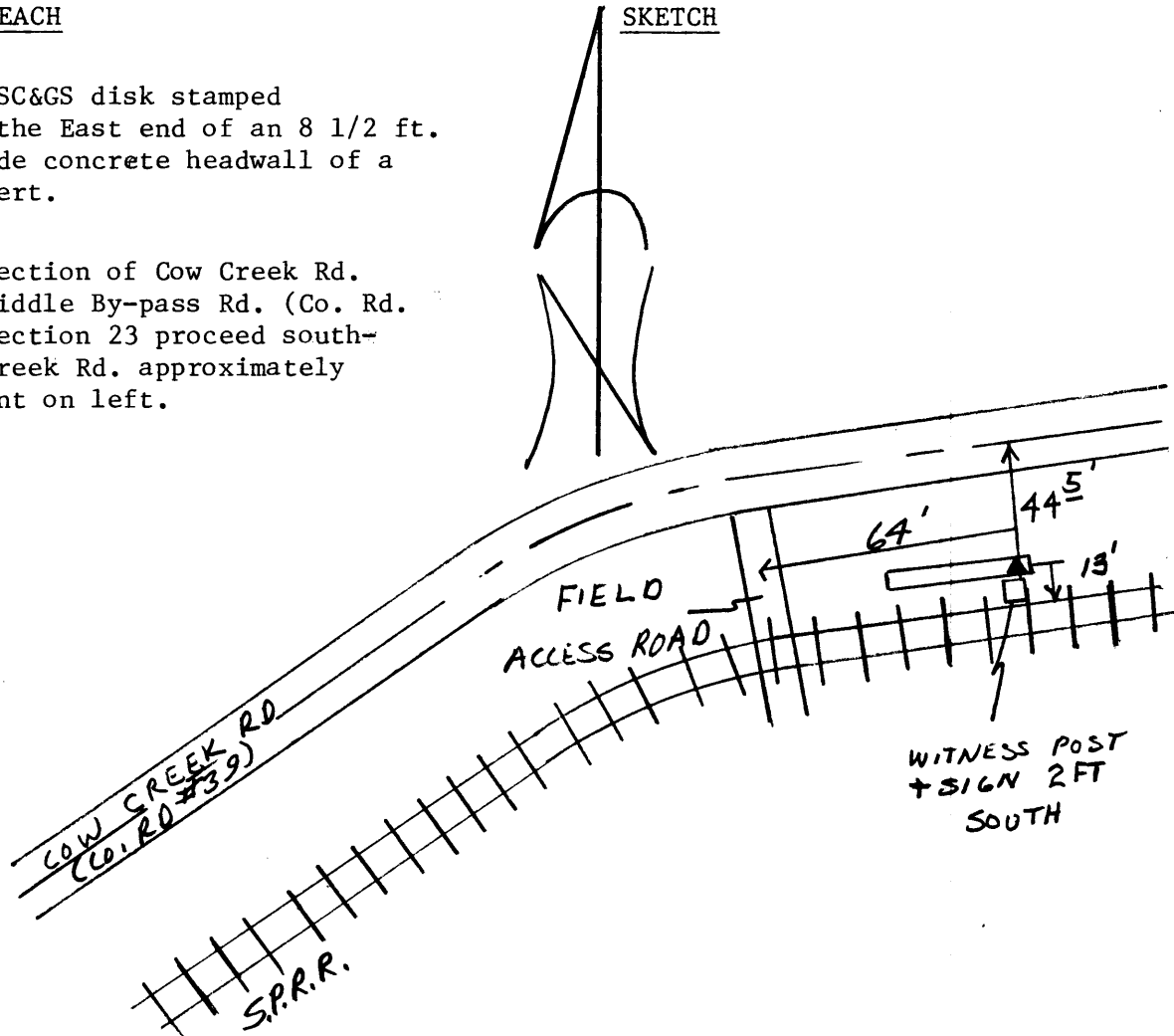

Reference Marks:

Note: For further information, contact the Douglas County Surveyor's Office, Room 205 Douglas County Justice Building, Roseburg, OR 97470. Phone 440-4278. Douglas County residents outside the Roseburg calling area, dial toll free 1-800-452-0991.