

OFFICE OF THE  
DOUGLAS COUNTY SURVEYOR

Station: W 76 RESET T 30 S, R 9 W, Sec 17

Set By (Agency): NGS

Date Set: 1975

Recovered By PB,RS

Date Recovered 11/16/83

Recovered By \_\_\_\_\_

Date Recovered \_\_\_\_\_

Recovered By \_\_\_\_\_

Date Recovered \_\_\_\_\_

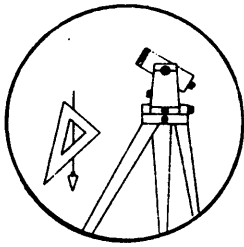

W-002

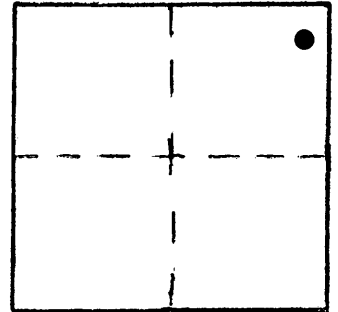

VERTICAL CONTROL **NGVD 29**

Elevation: 575.599 NGS Line # 27 USGS Line # \_\_\_\_\_ OSHD Line # \_\_\_\_\_

Precision: 2nd Agency: NGS Proj. # \_\_\_\_\_ Date: 1975

HORIZONTAL CONTROL

South Zone State Plane Coordinates: Y(Northing) \_\_\_\_\_ X(Easting) \_\_\_\_\_

Precision: \_\_\_\_\_ Agency: \_\_\_\_\_ Proj. # \_\_\_\_\_ Date: \_\_\_\_\_

Approximate Geographic Position: Latitude \_\_\_\_\_ Longitude \_\_\_\_\_

DESCRIPTION and TO REACH

SKETCH

**DESCRIPTION:**

A disk stamped "W 76 RESET 1975" set flush in a boulder.

**TO REACH:**

From the intersection of State Hwy. 42 and Slater Creek Rd. in T30S,R9W, Sec.17; proceed easterly along State Hwy. 42 0.60 miles to monument on right.

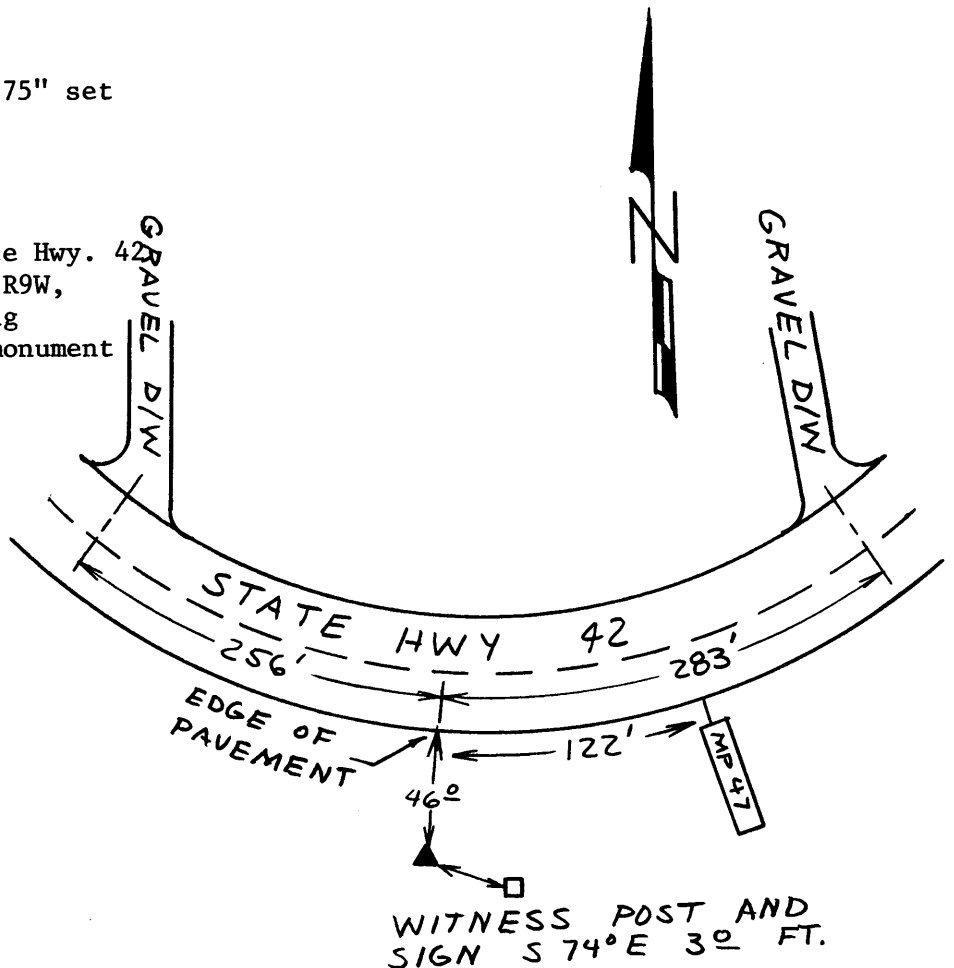

**Reference Marks:**

Note: For further information, contact the Douglas County Surveyor's Office, Room 205 Douglas County Justice Building, Roseburg, OR 97470. Phone 440-4278. Douglas County residents outside the Roseburg calling area, dial toll free 1-800-452-0991.