

OFFICE OF THE
DOUGLAS COUNTY SURVEYOR

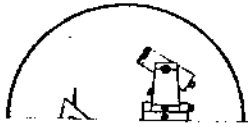

v-011
V 554

22S 5W 34

NAD 722412.77 4183461.07
83 43°36'55" 123°17' 9"

Station: V554 T 22 S, R 5 W , Sec 34
Set By (Agency): USC&GS
Date Set: 1954
Recovered By RWS, SJF
Date Recovered 9/14/87
Recovered By _____
Date Recovered _____
Recovered By _____
Date Recovered _____

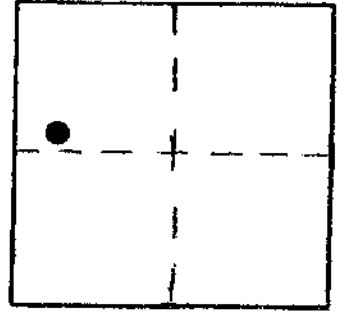

VERTICAL CONTROL

Elevation: 346.049 NGS Line # 6 USGS Line # _____ OSHD Line # _____
Precision: 1st Agency: USC&GS Proj. # _____ Date: 1957

HORIZONTAL CONTROL

South Zone State Plane Coordinates: Y(Northing) 722,447.53 X(Easting) 1,262,700.69
Precision: 1/15,000 Agency: DCSO Proj. # 2008 Date: 1979
Approximate Geographic Position: Latitude 43°36'55" Longitude 123°17'05"

DESCRIPTION and TO REACH

A USC&GS disk stamped "V554 1954" set in the south end of a 1ft. by 8 1/2ft. long concrete headwall of a 24 in. dia. box culvert.

TO REACH:

From the intersection of Main St. and Hwy 99 in Yoncalla, T23S, R5W, Sec. 3, proceed northerly along State Hwy 99 1.1 miles to monument on right.

Reference Marks:

SKETCH

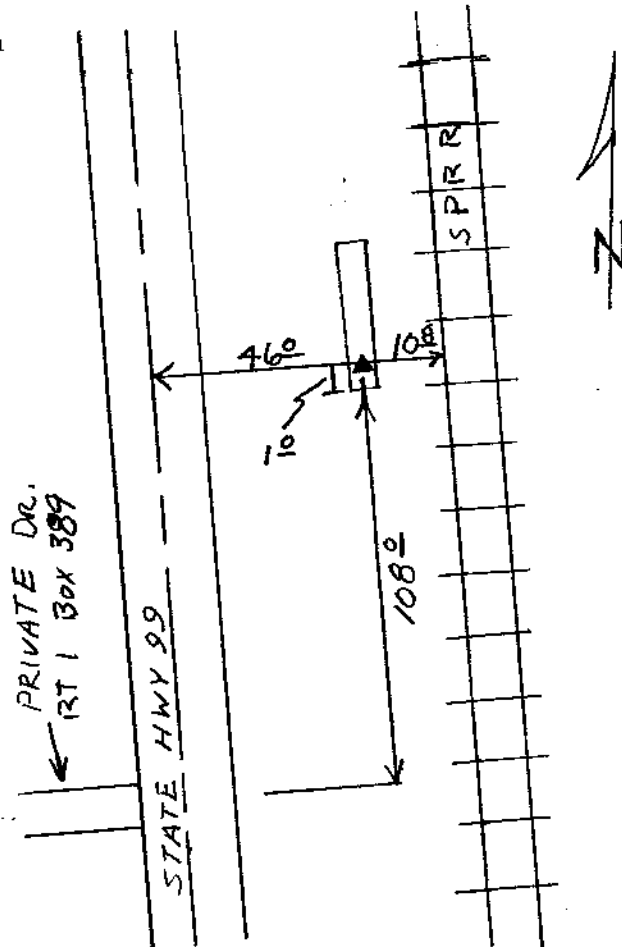

Note: For further information, contact the Douglas County Surveyor's Office, Room 205 Douglas County Justice Building, Roseburg, OR 97470. Phone 440-4278. Douglas County residents outside the Roseburg calling area, dial toll free 1-800-452-0991.