

OFFICE OF THE
DOUGLAS COUNTY SURVEYOR

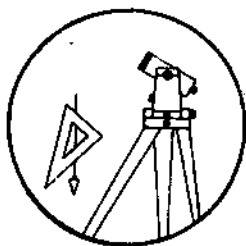

Station: V 344 T 28 S, R 8 W, Sec 8
 Set By (Agency): USC&GS
 Date Set: 1942
 Recovered By RS, SF
 Date Recovered 8/9/84
 Recovered By _____
 Date Recovered _____
 Recovered By _____
 Date Recovered _____

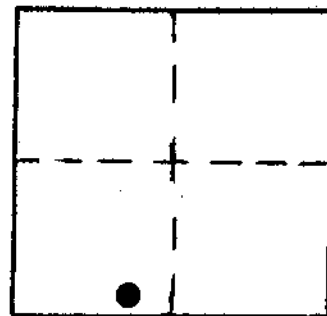

V-006

VERTICAL CONTROL NG-VD 29

Elevation: 2820.368 NGS Line # 99 USGS Line # _____ OSHD Line # _____
 Precision: 2nd Agency: USC&GS Proj. # _____ Date: 1957

HORIZONTAL CONTROL

South Zone State Plane Coordinates: Y(Northing) _____ X(Easting) _____
 Precision: _____ Agency: _____ Proj. # _____ Date: _____
 Approximate Geographic Position: Latitude _____ Longitude _____

DESCRIPTION and TO REACH

DESCRIPTION:

A USC&GS disk stamped "V 344 1942"
 set in a 9"X9" concrete post flush
 with ground.

TO REACH:

From the intersection of BLM Rd. #28-8-16
 and Co. Rd. #112 (Coos Bay Wagon Rd.) in T28S,
 R8W, Sec.16, proceed northerly along BLM Rd. #
 28-8-16, 4.3 miles to its intersection with
 BLM Rd. #28-8-20; proceed southerly along
 BLM Rd. #28-8-20, 3.15 miles to monument on
 right.

SKETCH

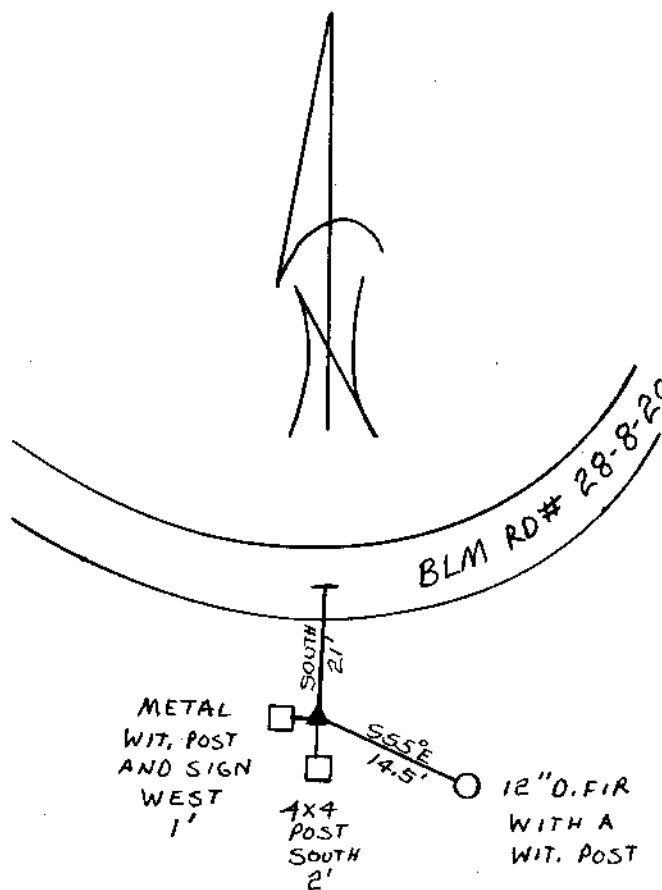

Reference Marks:

Note: For further information, contact the Douglas County Surveyor's Office, Room 205
 Douglas County Justice Building, Roseburg, OR 97470. Phone 440-4278. Douglas
 County residents outside the Roseburg calling area, dial toll free 1-800-452-0991.