

DOUGLAS COUNTY SURVEYOR'S OFFICE

Designation: U-150 Station: UMPLIGHT T 22S R 13W S 13 ¼ NW

Date Set: 4-20-2006 Set by (Agency): DCSO

Date Recovered: 4-20-2006 Recovered by: SJF, JAP

- Found New Reset
 Not Found Referenced Destroyed

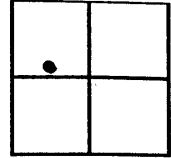

VERTICAL CONTROL

NGVD 29 Elevation: 110.34 Feet File # CS 67/19
 Precision: 3rd Agency: DCSO Project: _____ Date: 2006
 NAVD 88 Elevation: _____ Meters File # _____
 Precision: _____ Agency: _____ Project: _____ Date: _____

HORIZONTAL CONTROL - south zone

N 749178.11 E 3942813.58 Datum/Adj.: NAD 83 Precision: GIS
 Lat: 43:39:46.84 Long: 124:11:56.00 Agency: PRIVATE File # CS 67/19 Date: 2006
 N _____ E _____ Datum/Adj.: _____ Precision: _____
 Lat: _____ Long: _____ Agency: _____ File # _____ Date: _____
 N _____ E _____ Datum/Adj.: _____ Precision: _____
 Lat: _____ Long: _____ Agency: _____ File # _____ Date: _____
 N _____ E _____ Datum/Adj.: _____ Precision: _____
 Lat: _____ Long: _____ Agency: _____ File # _____ Date: _____

DESCRIPTION AND TO REACH

A 5/8 INCH DIAM., 5 FOOT LONG REBAR
CENTER-PUNCHED AND DRIVEN APPROX. 0.5 FEET
BELOW SURFACE OF A.C. PAVED PARKING AREA.
FROM THE INTERSECTION OF SALMON
HARBOR DRIVE (Co. Rd. #251) AND LIGHT-
HOUSE ROAD (Co. Rd. #87) IN T22S, R13W,
SECTION 13 PROCEED SOUTHERLY ALONG
LIGHTHOUSE ROAD (Co. Rd. #87) APPROX.
0.55 MILES TO THE NORTH END OF THE SCENIC
OVERLOOK PARKING AREA, SITUATED JUST WEST
OF THE UMPQUA LIGHTHOUSE, AND THE MON-
UMENT ON THE RIGHT. (SEE SKETCH)

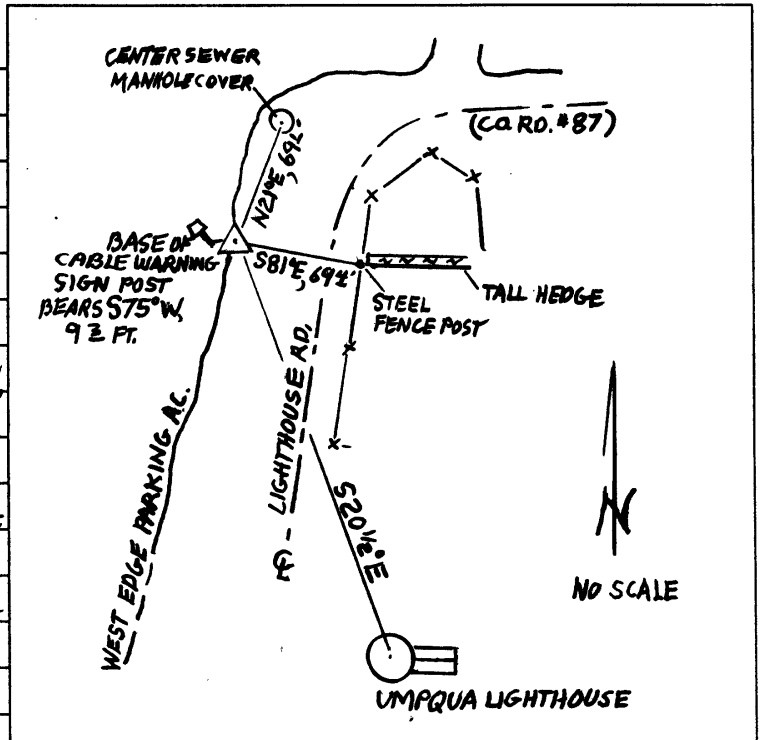

PHOTO FILE NAME

LOCATION

#100-1291 (3/12/08 Renamed U-150)

PROCESSED BY: _____

DATE: _____



9.20.2006