

OFFICE OF THE
DOUGLAS COUNTY SURVEYOR

Station: U 749

T27S R6W Sec. 36

Date Set: 1987

Set By (Agency): NGS

DCSO Designation: U-143

Date Recovered: 9-93

Recovered By: RWS SJF

Date Recovered: _____

Recovered By: _____

Date Recovered: _____

Recovered By: _____

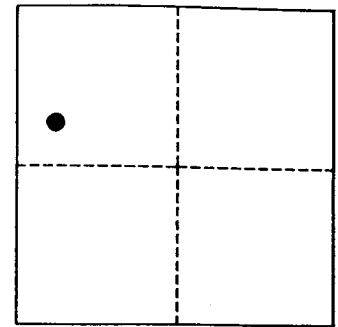
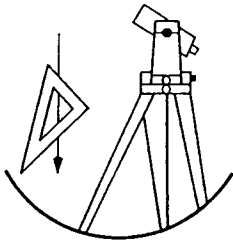

VERTICAL CONTROL

~~NAVD 88~~
NAVD 88 Elevation: 529,760 FEET NAVD 88 Elevation: 161.471 METERS

NGS Line # 125035 USGS LINE # _____ OSHD Line # _____ FILE # _____

Precision: 1ST ORDER Agency: NGS Proj: _____ Date: 1988

HORIZONTAL CONTROL

O.C.S. 27 Y(Northing): _____ O.C.S. 83 Y(Northing): 564824

(South Zone) X(Easting): _____ (South Zone) X(Easting): 4157417

Precision: GIS SCALED Agency: DCSO Proj: _____ Date: 2014

Approx. O.C.S. 27 Geographic Position: Latitude: 43°10'50" Longitude: 123°21'47"

Approx. O.C.S. 83 Geographic Position: Latitude: _____ Longitude: _____

Found: A 3 - 5/8 inch diameter NGS disk stamped "U 749 1987" set in rock cut bank.

To reach: From the intersection of state Hwy 99 and Tipton Rd. in T27S R6W Sec25, proceed southerly along State Hwy 99, 0.8 miles to monument on right.

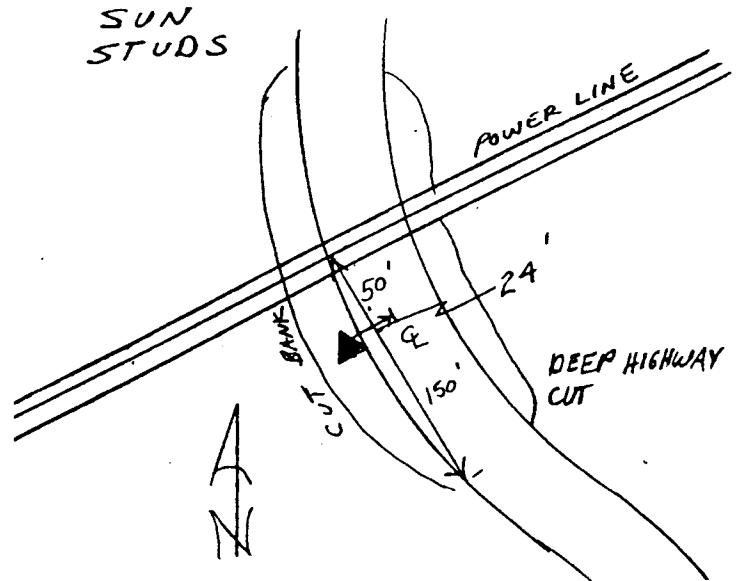

Note: For further information contact the Douglas County Surveyors Office, Room 205 Douglas County Justice Building, Roseburg, OR 97470. Phone 440-4272. Douglas County Residents outside Roseburg calling area, dial toll free 1-800-477-0991.