

OFFICE OF THE
DOUGLAS COUNTY SURVEYOR

Station: U 747

T31S R5W Sec. 35

Date Set: 1987

Set By (Agency): NGS

DCSO Designation: U-142

Date Recovered: 8-93

Recovered By: RWS S.JF

Date Recovered: _____

Recovered By: _____

Date Recovered: _____

Recovered By: _____

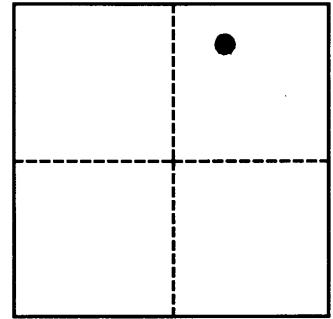
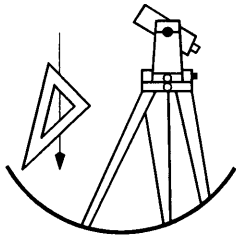

VERTICAL CONTROL

NGVD 29 Elevation: _____ FEET NAVD 88 Elevation: 563.000 METERS

NGS Line # L25042 USGS LINE # _____ OSHD Line # _____ FILE # _____

Precision: 1ST ORDER Agency: NGS Proj: _____ Date: 1988

HORIZONTAL CONTROL

O.C.S. 27 Y(Northing): _____ O.C.S. 83 Y(Northing): _____

(South Zone) X(Easting): _____ (South Zone) X(Easting): _____

Precision: _____ Agency: _____ Proj: _____ Date: _____

Approx. O.C.S. 27 Geographic Position: Latitude: 42°50'14" Longitude: 123°15'11"

Approx. O.C.S. 83 Geographic Position: Latitude: _____ Longitude: _____

Found: A 3 - 5/8 inch diameter disk stamped "U 747 1987" set flush in rock cut bank

To reach: From the intersection of I-5 and Upper Cow Creek Rd. (Co. Rd. #36) in T32S R5W Sec11 (exit 88) proceed northerly along I-5, 2.8 miles to monument on right at mile post 91.

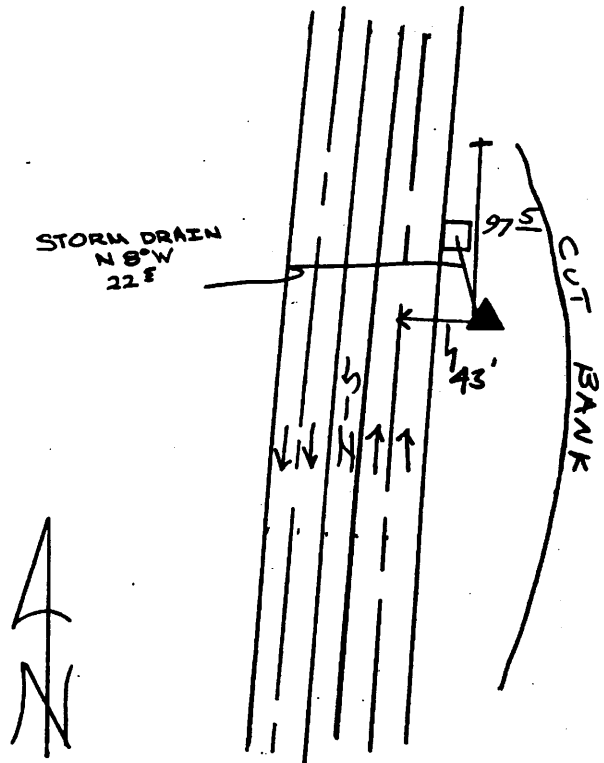

Note: For further information contact the Douglas County Surveyors Office, Room 205 Douglas County Justice Building, Roseburg, OR 97470. Phone 440-4272. Douglas County Residents outside Roseburg calling area, dial toll free 1-800-477-0991.