

OFFICE OF THE
DOUGLAS COUNTY SURVEYOR

Station: U 552 T 30 S, R 6 W , Sec 28

Set By (Agency): USC&GS

Date Set: 1954

Recovered By RWS, SJF

Date Recovered 11/7/88

Recovered By _____

Date Recovered _____

Recovered By _____

Date Recovered _____

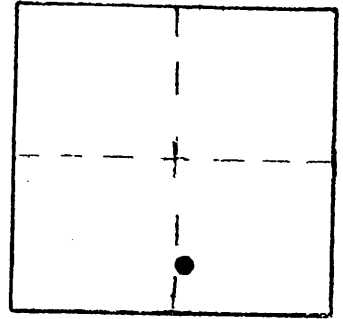

U-137
U 552
30S 6W 28

NAD 473457.68 4140555.54
83 42°55'43" 123°24'57"

VERTICAL CONTROL **NGVD 29**

Elevation: 724.743 NGS Line # 6 USGS Line # _____ OSHD Line # _____

Precision: 1st Agency: USC&GS Proj. # 2013 Date: 1957

HORIZONTAL CONTROL **OCS 27**

South Zone State Plane Coordinates: Y(Northing) 473,493.29 X(Easting) 1,219,597.01

Precision: 1/25,000 Agency: DCSD Proj. # 2008 Date: 1991

Approximate Geographic Position: Latitude _____ Longitude _____

DESCRIPTION and TO REACH

SKETCH

A 3 in. dia. USC&GS disk stamped "U 552 1954"
set in the east end of an 8 1/2 ft. by 1 1/2 ft.
by 3 1/2 ft. high concrete headwall of a 24 in.
dia. culvert.

TO REACH:

From the intersection of Cow Creek Rd, (Co.Rd.#39)
and Riddle By-Pass Rd. (Co.Rd.#263) in T30S,R6W,
Sec. 23, proceed southwesterly along Cow Creek Rd.
approximately 2.40 miles to Nickel Mountain Rd.
and S.P.R.R. tracks crossing County Rd., proceed
westerly along S.P.R.R. tracks approximately 600 ft.
to monument on left.

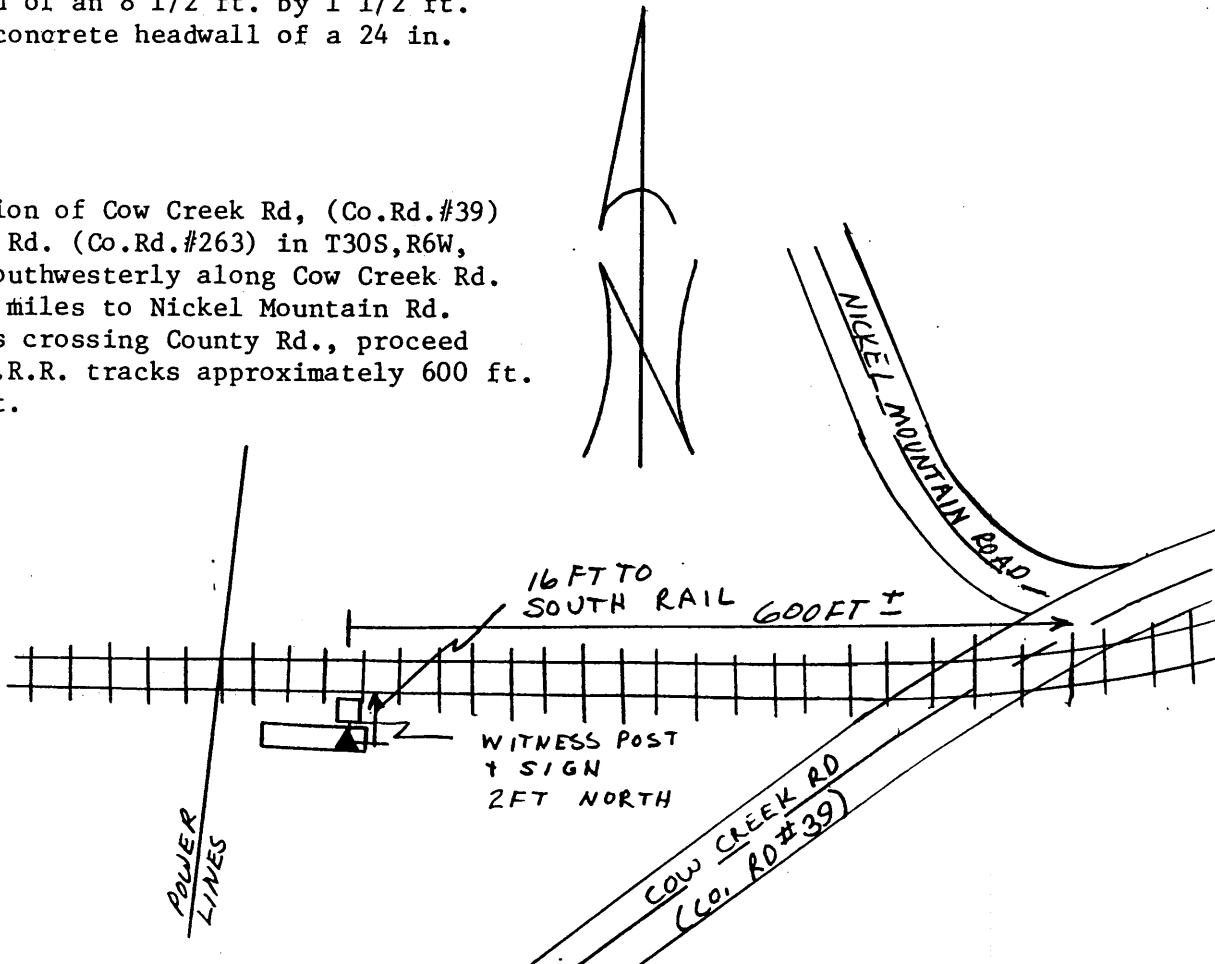

Reference Marks:

Note: For further information, contact the Douglas County Surveyor's Office, Room 205
Douglas County Justice Building, Roseburg, OR 97470. Phone 440-4278. Douglas
County residents outside the Roseburg calling area, dial toll free 1-800-452-0991.