

OFFICE OF THE  
DOUGLAS COUNTY SURVEYOR

Station: U-77 T 22 S, R 10W , Sec 14

Set By (Agency): DCSO

Date Set: 1973

Recovered By GQ-RWS

Date Recovered 2-16-82

Recovered By \_\_\_\_\_

Date Recovered \_\_\_\_\_

Recovered By \_\_\_\_\_

Date Recovered \_\_\_\_\_

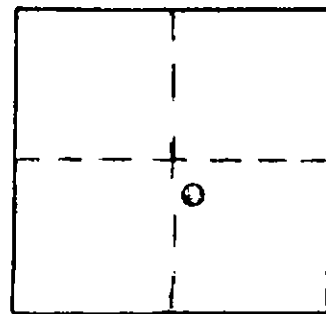

u-080  
u-77

NAB 742809.17 4058169.57  
88 43°39'22" 123°51'20"

VERTICAL CONTROL

Elevation: 39.228 NGS Line # \_\_\_\_\_ USGS Line # \_\_\_\_\_ OSHD Line # \_\_\_\_\_

Precision: 3rd Agency: DCSO Proj. # 2006 Date: 1972

HORIZONTAL CONTROL

South Zone State Plane Coordinates: Y(Northing) 742,843.87 X(Easting) 1,112,209.19

Precision: 1/25,000 Agency: DCSO Proj. # 2006 Date: 1974

Approximate Geographic Position: Latitude 43°39'22" Longitude 123°51'20"

DESCRIPTION and TO REACH

SKETCH

Found: A standard DCSO disk set in a boulder stamped "U-77 1973".

To reach: From the intersection of Hwy. 38 & Co. Rd. #3 (in sec. 15 T22S R10W) Proceed East-erly along Hwy. 38 1.05 miles to monument on the left.

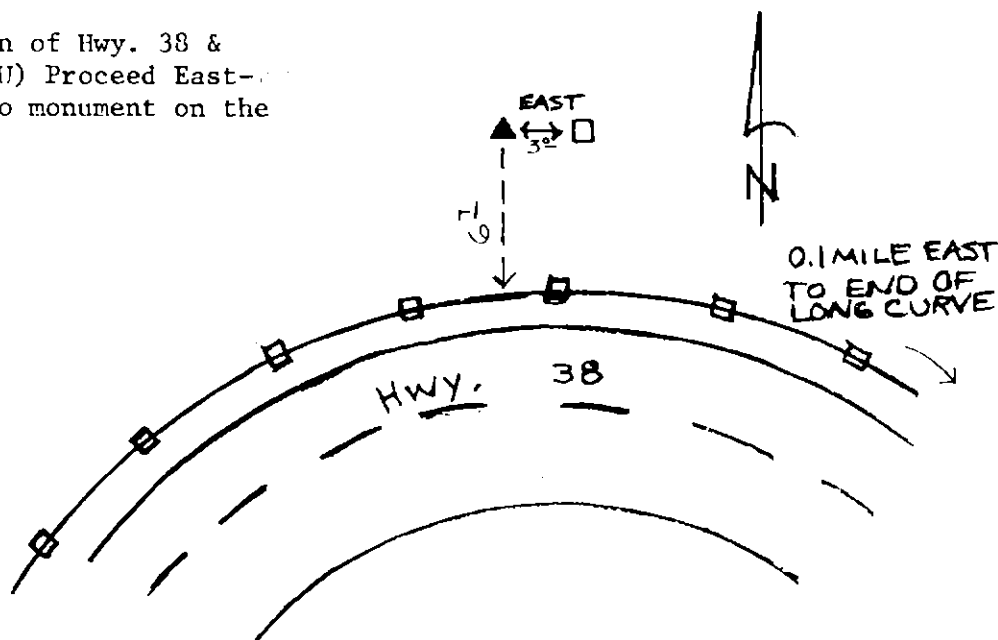

Reference Marks:

Note: For further information, contact the Douglas County Surveyor's Office, Room 205 Douglas County Justice Building, Roseburg, OR 97470. Phone 440-4278. Douglas County residents outside the Roseburg calling area, dial toll free 1-800-452-0991.