

OFFICE OF THE  
DOUGLAS COUNTY SURVEYOR

Station: U-74 T 22 S, R 9W, Sec 18

Set By (Agency): DCSO

Date Set: 1972

Recovered By G.Q. T.P.

Date Recovered 1-7-82

Recovered By JP 11/2000

Date Recovered \_\_\_\_\_

Recovered By \_\_\_\_\_

Date Recovered \_\_\_\_\_

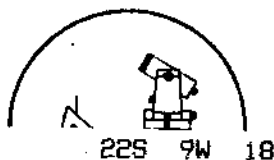
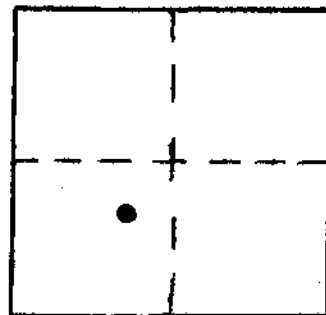

u-075  
U-74

NAD 741667.06 4043516.20  
83 43°39'14" 123°49' 3"

**DESIGNATION U-075**

VERTICAL CONTROL

Elevation: 47.680 NGS Line # \_\_\_\_\_ USGS Line # \_\_\_\_\_ OSHD Line # \_\_\_\_\_

Precision: 2nd Agency: DCSO Proj. # 2006 Date: 1972

HORIZONTAL CONTROL

South Zone State Plane Coordinates: Y(Northing) 741,703.80 X(Easting) 1,122,555.83

Precision: 1/10,000 Agency: DCSO Proj. # 2006 Date: 1973

Approximate Geographic Position: Latitude 43°39'15" Longitude 123°48'59"

DESCRIPTION and TO REACH

SKETCH

Found: A standard DCSO disk set in concrete tile marked "U-74 1972". Survey marker is along South side.

To Reach: From the intersection of Co. Rd. #240 & Hwy. 38 (in sec. 18 T22S R9W) proceed easterly into Scottsburg 0.3 mi. to Historical marker sign and monument on the right.

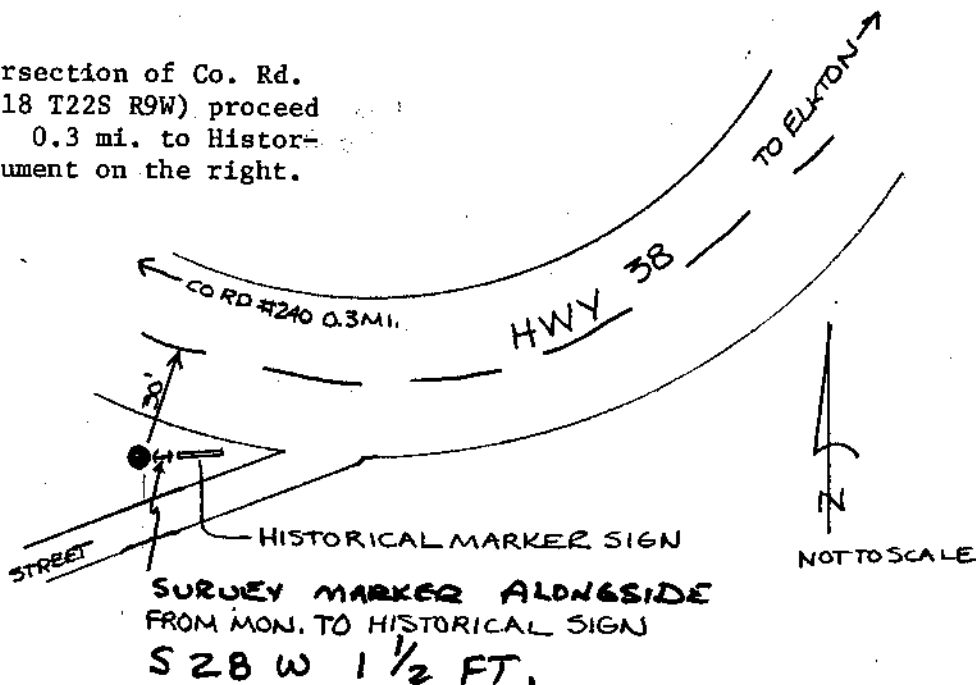

Reference Marks:

Note: For further information, contact the Douglas County Surveyor's Office, Room 205 Douglas County Justice Building, Roseburg, OR 97470. Phone 440-4278. Douglas County residents outside the Roseburg calling area, dial toll free 1-800-452-0991.