

OFFICE OF THE  
DOUGLAS COUNTY SURVEYOR

Station: U55 T 22 S, R 7 W, Sec 30

Set By (Agency): DCSO

Date Set: 1972

Recovered By RWS, SJF

Date Recovered 4/28/87

Recovered By 10/98 DCSO

Date Recovered \_\_\_\_\_

Recovered By \_\_\_\_\_

Date Recovered \_\_\_\_\_

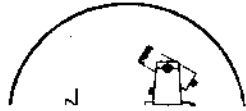
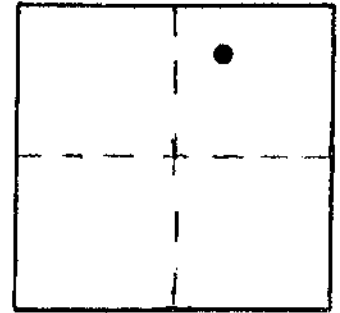

u-056  
U 55  
22S 7W 30

NAD 731316.24 4108098.11  
83 43°37'57" 123°34'20"

VERTICAL CONTROL

Elevation: 113.88 NGS Line # \_\_\_\_\_ USGS Line # \_\_\_\_\_ OSHD Line # \_\_\_\_\_

Precision: 3rd Agency: DCSO Proj. # CS 66/52 Date: 1998

HORIZONTAL CONTROL

South Zone State Plane Coordinates: Y(Northing) 731,351.16 X(Easting) 1,187,137.89

Precision: 1/10,000 Agency: DCSO Proj. # 2006 Date: 1972

Approximate Geographic Position: Latitude 43°37'57" Longitude 123°34'16"

DESCRIPTION and TO REACH

SKETCH

A DCSO disk stamped "U55:1972" set in concrete approx. 6 in. below road shoulder surface.

TO REACH:

Go to the intersection of Mehl Creek Rd. (Co. Rd. #11) and Henderer Rd. (Co. Rd. #118) in T22S, R7W, Sec.30. Monument lies at east edge of Henderer Road at center of a cattle undercrossing approx. 170 ft. north of intersection.

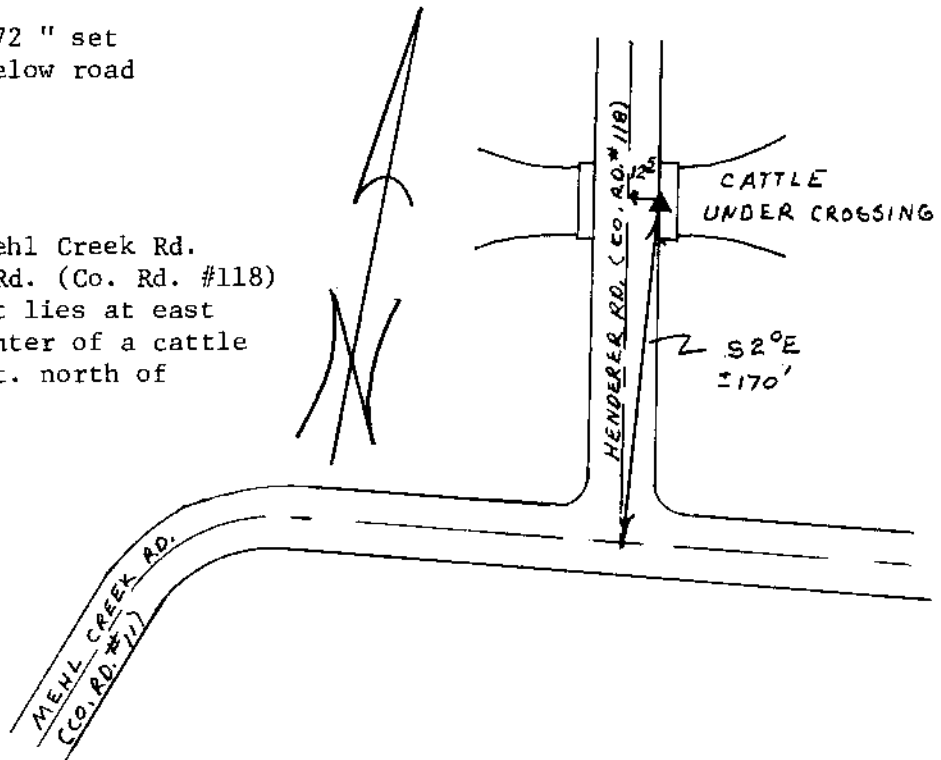

Reference Marks:

Note: For further information, contact the Douglas County Surveyor's Office, Room 205 Douglas County Justice Building, Roseburg, OR 97470. Phone 440-4278. Douglas County residents outside the Roseburg calling area, dial toll free 1-800-452-0991.