

DOUGLAS COUNTY SURVEYOR'S OFFICE

100 - 1100

Designation: U-039 Station: U-37 T 23 S R 7 W S 30 1/4 SW

Date Set: 1972 Set by (Agency): DCSO

Date Recovered: 4-3-03 Recovered by: RWS SJF

- Found New Reset
 Not Found Referenced Destroyed

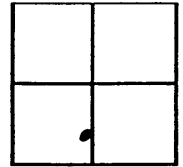

VERTICAL CONTROL

NGVD 29 Elevation: 257.984 Feet File # _____
 Precision: 2nd Agency: DCSO Project: 2006 Date: 1972
 NAVD 88 Elevation: _____ Meters File # _____
 Precision: _____ Agency: _____ Project: _____ Date: _____

HORIZONTAL CONTROL - south zone

N 696,749.63 E 1,185,089.87 Datum/Adj. 1927 Precision: 1/25,000
 Lat: 43° 32' 15" Long: 123° 34' 26" Agency: DCSO File # 2006 Date: 1972
 N 696,714.88 E 4,106,049.60 Datum/Adj.: NAO 83 Precision: ?
 Lat: 43° 32' 14" Long: 123° 34' 30" Agency: DCSO File # ? Date: ?
 N _____ E _____ Datum/Adj.: _____ Precision: _____
 Lat: _____ Long: _____ Agency: _____ File # _____ Date: _____
 N _____ E _____ Datum/Adj.: _____ Precision: _____
 Lat: _____ Long: _____ Agency: _____ File # _____ Date: _____

DESCRIPTION AND TO REACH

DCSO DRILL CAP STAMPED
"U 37 1972" SET IN AN
9" DIA CONCRETE FILLED CONCRETE
TILE, PROTRUS 5" ABOVE GROUND
FROM THE INTERSECTION OF STATE
HIGHWAY 138 AND BULLOCK
ROAD (COARD #57) IN T23S
R7W, SEC 20 AT KELLOGG
PROCEED SOUTHWESTERLY ALONG
BULLOCK ROAD 2.2 MILES TO
MONUMENT ON RIGHT
6.7 MILES NW'LY OF
TREE ON BULLOCK ROAD

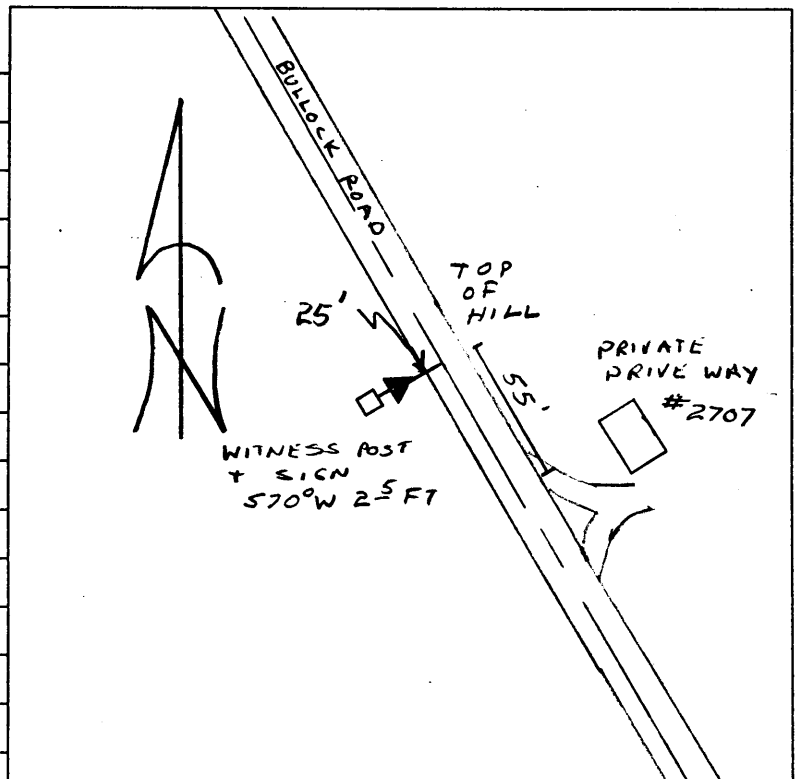

U-37

570°W 2.5 FT



7. 26. 1999