

OFFICE OF THE  
DOUGLAS COUNTY SURVEYOR

Station: U-32 T 24 S, R 7W, Sec 2

Set By (Agency): DCSO

Date Set: 1972

Recovered By GO-JP

Date Recovered 1-7-82

Recovered By \_\_\_\_\_

Date Recovered \_\_\_\_\_

Recovered By \_\_\_\_\_

Date Recovered \_\_\_\_\_

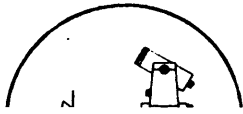
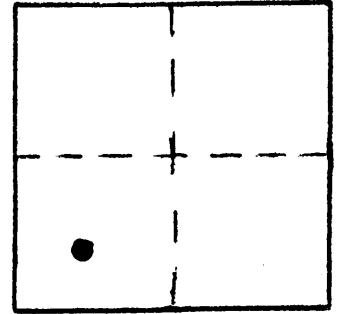

U-034  
U-32

24S 7W 2

NAD 685131.39 4125765.73  
82 43°30'27" 123°29'57"

VERTICAL CONTROL NGVD 29

Elevation: 224.912 NGS Line # \_\_\_\_\_ USGS Line # \_\_\_\_\_ OSHD Line # \_\_\_\_\_

Precision: 2nd Agency: DCSO Proj. # 2006 Date: 1974

HORIZONTAL CONTROL NAD 27

South Zone State Plane Coordinates: Y(Northing) 685,166.17 X(Easting) 1,204,806.20

Precision: 1/25,000 Agency: DCSO Proj. # 2006 Date: 1972

Approximate Geographic Position: Latitude 43°30'28" Longitude 123°29'53"

DESCRIPTION and TO REACH

SKETCH

Found: A standard DCSO disk set in a boulder flush with the ground marked "U-32 1972".  
Survey marker sign along Southerly side of station.

To reach: From the intersection of Co. Rd. #57 & Hwy. 138 (sec. 13 T24S R7W) proceed westerly along Hwy. 138 2.3 miles to station on the left.

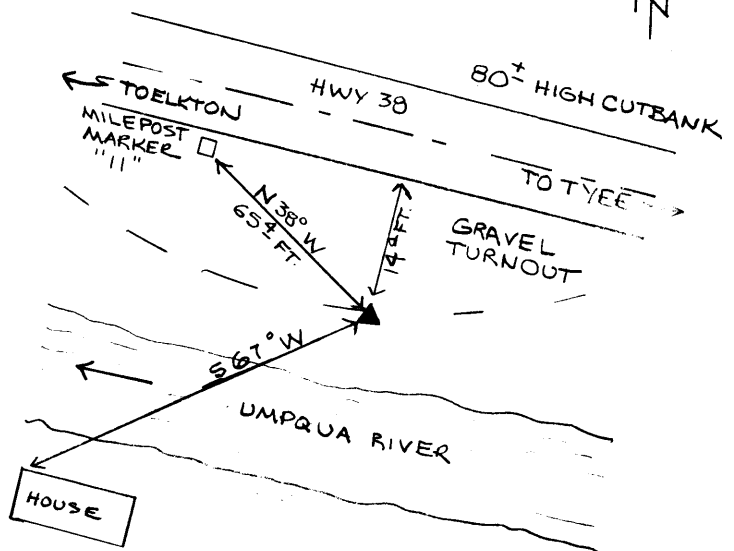
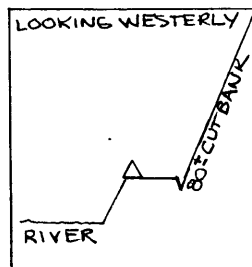

Reference Marks:

Note: For further information, contact the Douglas County Surveyor's Office, Room 205 Douglas County Justice Building, Roseburg, OR 97470. Phone 440-4278. Douglas County residents outside the Roseburg calling area, dial toll free 1-800-452-0991.