

DOUGLAS COUNTY SURVEYOR'S OFFICE

Designation: T-090 Station: TOY T 225 R 6W S 13 1/4 A

Date Set: NOV. 20, 2003 Set by (Agency): DCSO

Date Recovered: 11/03 Recovered by: SJF, JAP

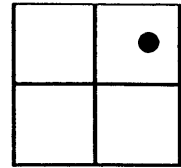

- Found New Reset
 Not Found Referenced Destroyed

VERTICAL CONTROL

NGVD 29 Elevation: 268.52 Feet File # CS 66/24
 Precision: 3RD. Agency: DCSO Project: _____ Date: 9/04
 NAVD 88 Elevation: _____ Meters File # _____
 Precision: _____ Agency: _____ Project: _____ Date: _____

HORIZONTAL CONTROL - south zone

N _____ E _____ Datum/Adj.: 1983 Precision: GIS
 Lat: 43°39'38.5" Long: 123°20'57.9" Agency: DCSO File # C.S. 66/24 Date: 6/06
 N _____ E _____ Datum/Adj.: _____ Precision: _____
 Lat: _____ Long: _____ Agency: _____ File # _____ Date: _____
 N _____ E _____ Datum/Adj.: _____ Precision: _____
 Lat: _____ Long: _____ Agency: _____ File # _____ Date: _____
 N _____ E _____ Datum/Adj.: _____ Precision: _____
 Lat: _____ Long: _____ Agency: _____ File # _____ Date: _____

DESCRIPTION AND TO REACH

A DCSO DISK STAMPED "TOY 2003" SET NEAR NORTH END OF CONCRETE FOOTING FOR LOW WOODEN PROPERTY-LINE FENCE.

FROM THE INTERSECTION OF HAYHURST RD. (CO. RD. #24) AND SOUTH ELK CREEK RD. (CO. RD. #197) IN T22S, R5W, SECTION 18 PROCEED WESTERLY ALONG SOUTH ELK CREEK RD. APPROXIMATELY 0.50 MILES TO MONUMENT ON LEFT.

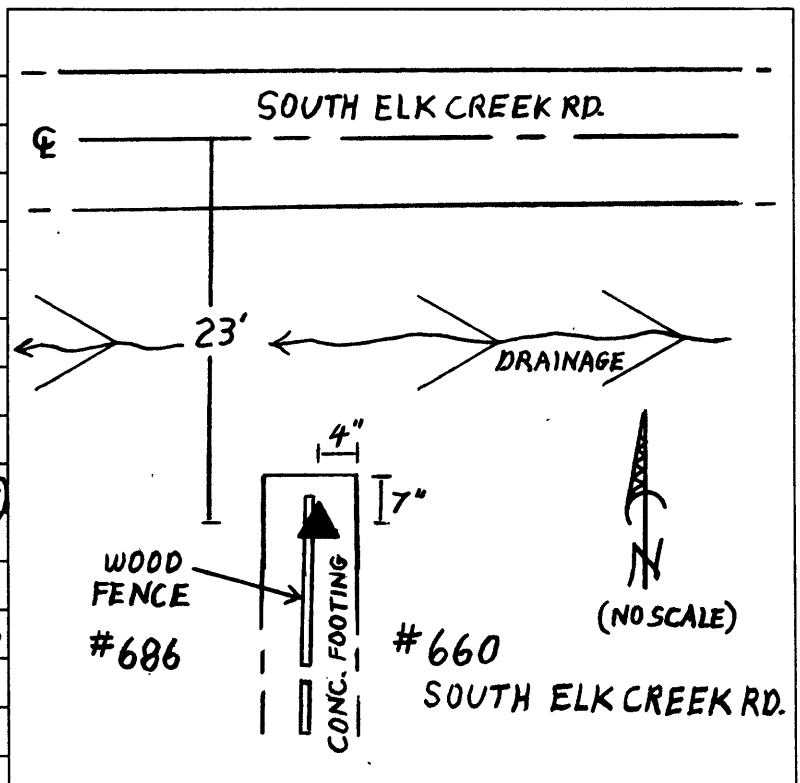



12. 5. 1999