

write/rain T-085

OFFICE OF THE

DOUGLAS COUNTY SURVEYOR

Station: THUNDER

T 27 S, R 3 W, Sec 2

Date Set: 1999

Set By (Agency): DCSO

Date Recovered: 10-21-99

Recovered By: RWS SJF

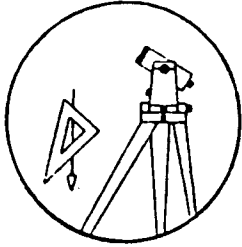

- Found
- New
- Reset
- Not Found
- Referenced
- Destroyed

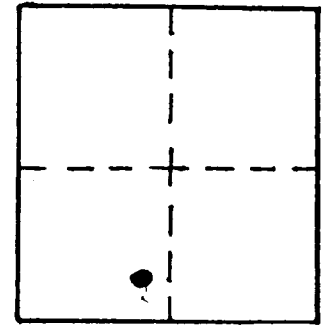

VERTICAL CONTROL

Elevation: 866.17 NGS Line # _____ USGS Line # _____ OSHD Line # _____

Precision: 3rd Agency: DCSO Proj. # 2007 Date: 1999

HORIZONTAL CONTROL CORPSCON6 NAVD88 869.75 FT. CS66/56

South Zone O.C.S. 27: Y(Northing) _____ X(Easting) _____

South Zone O.C.S. 83: Y(Northing) 585020 X(Easting) 4249544

Precision: GIS SCALED Agency: DCSO Proj. # _____ Date: 2014

Approx. ⁰⁰⁵²⁷ ~~NA803~~ Geographic Position: Latitude 43°14'39" Longitude 123°01'14"

DESCRIPTION and TO REACH

DCSO DRILL CAP SET IN OLD WESTERLY
BRIDGE PIER ON SOUTH SIDE OF
LITTLE RIVER ROAD.

GO TO THE INTERSECTION OF LITTLE RIVER
ROAD (CO. RD #176) AND CAVITT CREEK ROAD
(CO. RD #82) IN T27 S R3 W SEC. 2 MONUMENT
IS SOUTH EAST OF INTERSECTION

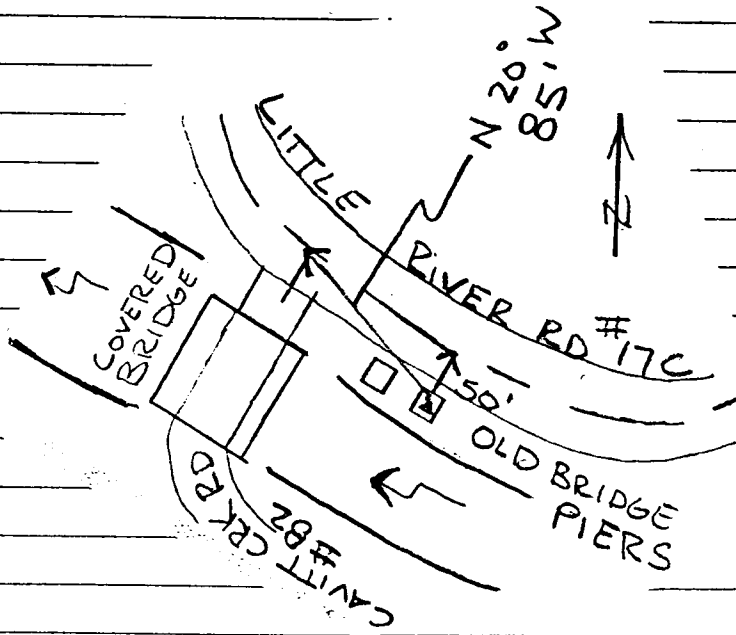

Reference Marks: