

OFFICE OF THE
DOUGLAS COUNTY SURVEYOR

Station: T 738

T21S R4W Sec. 10

Date Set: 1987

Set By (Agency): NGS

DCSO Designation: T-075

Date Recovered: 7-93

Recovered By: SJF

Date Recovered: _____

Recovered By: _____

Date Recovered: _____

Recovered By: _____

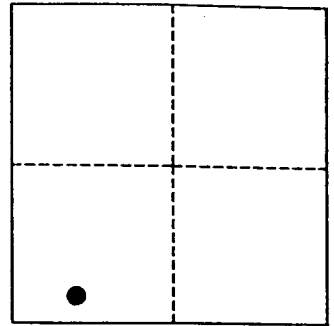
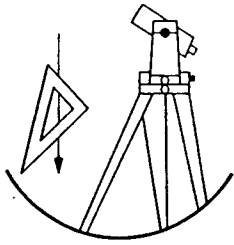

VERTICAL CONTROL

~~NGVD 29~~ ^{NAVD 88} Elevation: 552.641 FEET NAVD 88 Elevation: 168.445 METERS

NGS Line # L25035 USGS LINE # _____ OSHD Line # _____ FILE # _____

Precision: 1ST ORDER Agency: NGS Proj: _____ Date: 1988

HORIZONTAL CONTROL

O.C.S. 27 Y(Northing): _____ O.C.S. 83 Y(Northing): 771360

(South Zone) X(Easting): _____ (South Zone) X(Easting): 4217632

Precision: GIS SCALED Agency: DCSO Proj: _____ Date: 2014

Approx. O.C.S. 27 Geographic Position: Latitude: 43°45'09" Longitude: 123°09'42"

Approx. O.C.S. 83 Geographic Position: Latitude: _____ Longitude: _____

Found: A 9/16 inch diameter stainless steel rod under a 6 - 5/8 inch diameter aluminum access cover, access rim stamped "T 738 1987" set flush with ground.

To reach: From the under crossing of Bear Creek Rd. (Co. Rd. #62) and I-5, exit 163 in T21S R4W Sec19, proceed northerly along I-5 approx. 3.35 miles to mile point 167.35 to monument on west side of south bound lanes.

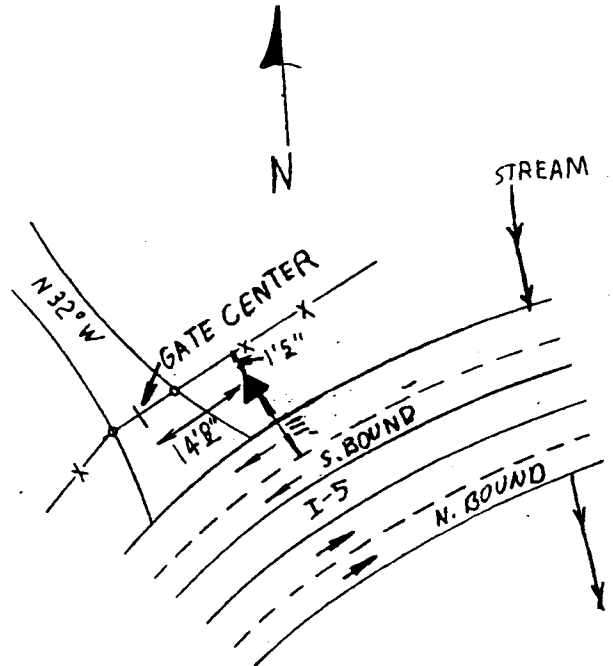

Note: For further information contact the Douglas County Surveyors Office, Room 205 Douglas County Justice Building, Roseburg, OR 97470. Phone 440-4272. Douglas County Residents outside Roseburg calling area, dial toll free 1-800-477-0991.