

OFFICE OF THE

DOUGLAS COUNTY SURVEYOR

t-057 245 SW 8
TURKEY HILL NO. 1

NAD 83 581344.04 4172692.76
43°30' 5" 123°19'19"

T 24 S, R 5W, Sec. 8

Station: Turkey Hill No. 1 1977

Set By (Agency): DCSO

Date: 1977

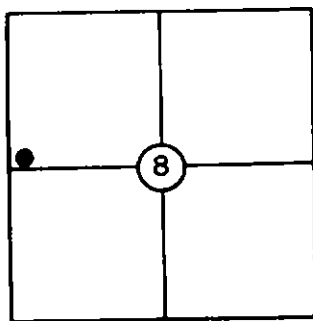

VERTICAL CONTROL

Elevation: _____ NGS(USC&GS) Line # _____ USGS Line # _____

Order Of Precision _____ Agency: _____ Proj. #: _____ Date: _____

HORIZONTAL CONTROL

Oregon State Plane Coordinates: Y(Northing) 681,378.39 X(Easting) 1,251,733.01
(South Zone)

C.S. 59/47

Order Of Precision 1/25,000 Agency: DCSO Proj. #: 2010-4 Date: 1978

Approximate Geographic Position: Latitude= 43° 30' 06" Longitude= 123° 19' 15"

DESCRIPTION: A standard DCSO bronze disk,
marked: "Turkey Hill No. 1 1977" set in a
drill hole at the SE corner of a 3 1/2 ft.
square concrete traffic counter foundation,
40 ft. S. of a 5/8" I.R. at Eng. Sta. 1330+50
along the W'stly R/W of I-5, 23 ft. S 45° E
of the W'stly R/W fence of I-5, and W'stly
across I-5 from station "Turkey Hill 1977 DCSO".

TO REACH: From the Rice Valley interchange
along I-5, proceed Sth'ly along the Frontage
Rd. on the West side of I-5, Approx. 0.8 mi. to
to the station on the left.

VICINITY: Approx. 0.8 mile South of the Rice Valley
exit. Along I-5 freeway.

SKETCH

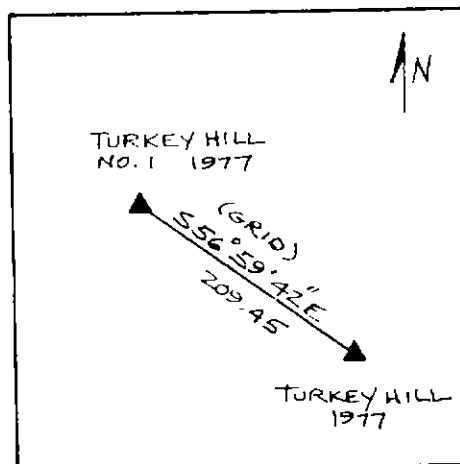

NOTE: For Possible Further Information On This Station, Please Contact The Douglas County Surveyors Office, Rm. 205 Douglas County Justice Bldg., Roseburg, OR. 97470 Phone 672-3311 Ext. 272. Douglas County residents outside the Roseburg calling area dial toll free 1-800-452-0991.