

11/18/81

t-056
TURKEY HILL

24S 5W 8

OFFICE OF THE

DOUGLAS COUNTY SURVEYOR

NAD 681229.94 4172868.41
83 43°30' 5" 123°19'17"

T 24 S, R 5W, Sec. 8

Station: Turkey Hill

Set By (Agency): DCSO

Date: 1977

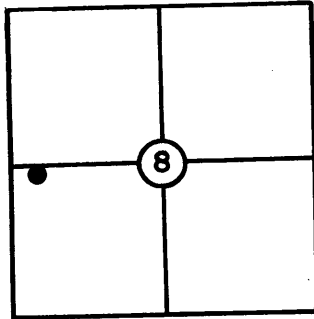

T-056

VERTICAL CONTROL

Elevation: _____ NGS(USC&GS) Line # _____ USGS Line # _____

Order Of Precision _____ Agency: _____ Proj. #: _____ Date: _____

HORIZONTAL CONTROL

NAD 27

Oregon State Plane Coordinates: Y(Northing) 681,264.30 X(Easting) 1,251,908.66
(South Zone)

Order Of Precision 1/25,000 Agency: DCSO Proj. #: 2010-4 Date: 1978

Approximate Geographic Position: Latitude= 43° 30' 05" Longitude= 123° 19' 12"
C.S. 59/47

DESCRIPTION: A Brass cap stamped "Turkey

Hill 1977" set in a drill hole in a 3 1/2

ft. sq. conc. footing near the SW cor of the

footing 4 ft W. of the E. R/W fence of I-5

between the freeway & a dead-end Frontage Rd.

47 ft. South of the South end of a freeway
guardrail, and 4 ft. West of a metal witness
post.

TO REACH: From the Rice Hill exit on I-5,
proceed Sth'ly on I-5 approx. 1.9 miles to
exit #146 thence 0.1 South on Frontage Rd.
and cross over freeway, thence 0.8 miles
Sth'ly along Frontage Rd. on East side of I-5
to the station.

VICINITY: Approx. 0.8 mi. S. of the Rice

Valley interchange along I-5.

SKETCH

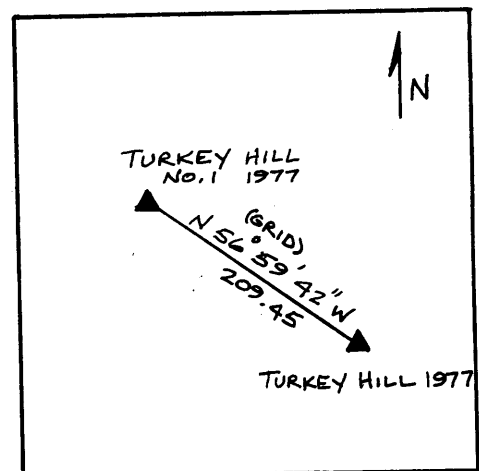

NOTE: For Possible Further Information On This Station, Please Contact The Douglas County Surveyors Office, Rm. 205 Douglas County Justice Bldg., Roseburg, OR. 97470 Phone 672-3311 Ext. 272.. Douglas County residents outside the Roseburg calling area dial toll free 1-800-452-0991.