

OFFICE OF THE
DOUGLAS COUNTY SURVEYOR

t-054
TTFN

25S 5W 6

NAD 651254.33 4166921.57
83 43°25' 7" 123°20'24"

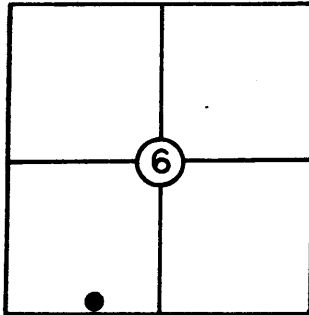

T-054

T 25 S, R 5 W, Sec. 6

Station: TTFN

Set By (Agency): DCSO

Date: 1980

VERTICAL CONTROL

N6VD 29

Elevation: 462.674 NGS(USC&GS) Line # _____ USGS Line # _____

Order _____ (Calapooya)
Of Precision 2nd-I Agency: DCSO Proj. #: 2006 Date: 1981

HORIZONTAL CONTROL

NAD 27

Oregon State Plane Coordinates: Y(Northing) 651,288.87 X(Easting) 1,245,962.35
(South Zone)

Order _____ (Calapooya)
Of Precision 1/25,000 Agency: DCSO Proj. #: 2006 Date: 1981

Approximate Geographic Position: Latitude= 43° 25' 07" Longitude= 123° 20' 19"

DESCRIPTION: A standard DCSO brass cap set in

a conc. filled 6"x42" belltile buried 40 in.

in the ground. 28 ft. N'ly on centerline

of Green Valley Rd. (Co. Rd. #23), 5 ft. S'ly

of R/W fence. Approx. 130 ft. Westerly of
Natural Gas Sub-station 67.4 ft. N72°W from
power pole #5-367 S. side of rd. 7.5 ft. above
pavement.

TO REACH: From intersection of Locust and

Hwy 99 in Oakland, proceed N'ly to Co. Rd. 23,

thence W'ly on Rd. 23, 2 mi. to monument on right.

Approx. 0.95 mi. from overpass of I-5 to station

VICINITY: Approx. 2 mi West of Oakland

on Co. Rd. 23

SKETCH

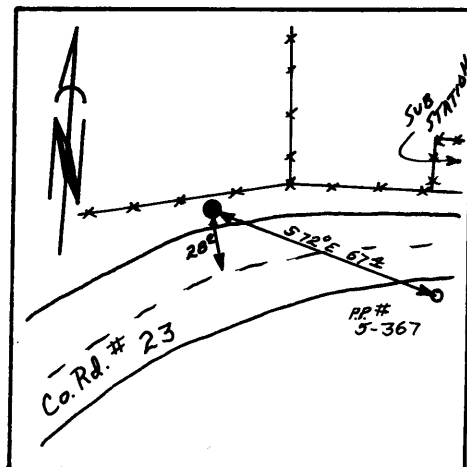

NOTE: For Possible Further Information On This Station, Please Contact The Douglas County Surveyors Office, Rm. 205 Douglas County Justice Bldg., Roseburg, OR. 97470 Phone 672-3311 Ext. 272. Douglas County residents outside the Roseburg calling area dial toll free 1-800-452-0991.