

Douglas County Geodetic Data Sheet

T 24 R 05 S 34

Station: TRUCKS
 Date Set: 1980 Set By (Agency): DCSO
 Last Date Recovered:

Designation: T-053

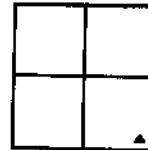

VERTICAL CONTROL

NGVD 29 Elevation:	526.069 Feet		
Precision: 2ND-I	Agency: DCSO	Project: 2006	Date: 1981
NAVD 88 Elevation:	Meters		
Precision:	Agency:	Project:	Date:
NGS Line #	USGS Line #	OSHD Line #	File #

HORIZONTAL CONTROL

OCS 27	Y(Northing): 655,779.72	X(Easting): 1,263,354.71	Lat:	Long:
Precision: 1/25,000	Agency: DCSO	Project: 2006	Date: 1981	
OCS 83	Y(Northing): 655,745.20	X(Easting): 4,184,314.11	Lat: 43°25'57"	Long: 123°16'30"
Precision:	Agency:	Project:	Date:	
OCS 83/91	Y(Northing):	X(Easting):	Lat:	Long:
Precision:	Agency:	Project:	Date:	
OCS 27 Scaled Latitude:	43°25'57"	OCS 27 Scaled Longitude:	123°16'26"	

DESCRIPTION:

A STANDARD DCSO BRASS CAP SET IN A 6X36 INCH CONCRETE FILLED BELLTILE STAMPED; TRUCKS 1980; PROTRUDING 3 INCHES FROM THE GROUND.

COMMENTS:

18 FT TO EDGE OF PAVEMENT OF CO RD 22 AND 5 FT ABOVE ROAD BED. 9.5 FT TO PP 3H 62 BEARING N54W 1.7 FT TO WITNESS POST AND 2.7 FT TO FENCE. VICINITY - APPROX 1.3 MILES FROM THE INTERSECTION OF OAK AND OLD HWY 99 IN THE TOWN OF OAKLAND.

SKETCH

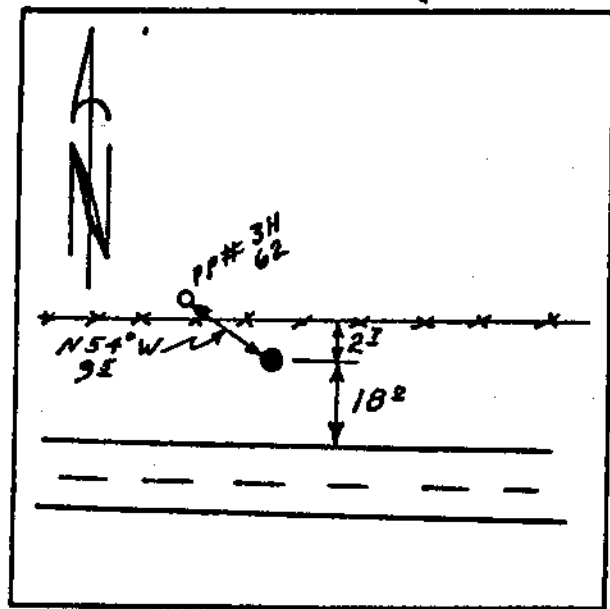

Note: For further information contact the Douglas County Surveyors Office, Room 105A Douglas County Courthouse, Roseburg, OR 97470. Phone 440-4272 or Fax (541)957-8150. Douglas County Residents outside Roseburg calling area, dial toll free 1-800-224-1619.