

OFFICE OF THE  
DOUGLAS COUNTY SURVEYOR

Station: TOTEM

T 22 S, R 7 W, Sec 12

Date Set: 1982

Set By (Agency): DCSO

DCSO Designation: T-045

Date Recovered: 2-23-82

Recovered By: LEM JP RS

Date Recovered: 7-91

Recovered By: TF

Date Recovered: \_\_\_\_\_

Recovered By: \_\_\_\_\_

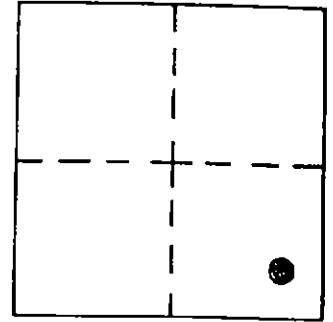
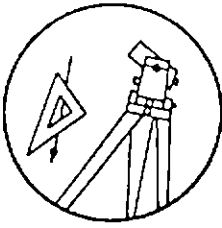

VERTICAL CONTROL

Elevation: 130.4

NGS Line # \_\_\_\_\_ USGS Line # \_\_\_\_\_ OSHD Line # \_\_\_\_\_

Precision: GPS Agency: DCSO

Proj. # 2008

Date: 1991

HORIZONTAL CONTROL

G.C.S. 27 Y(Northing): 742,945.00

G.C.S. 83 Y(Northing): 742,910.07

South Zone X(Easting): 1,214,567.30

South Zone X(Easting): 4,135,527.64

Precision: 1/10000 Agency: DCSO

Proj. # 2006

Date: 1982

Approx. NAD 83 Geographic Position: Latitude 43°40' 1"

Longitude 123°28'13"

Set: A standard disk stamped "Totem 1982" set in a 6" x 42" concrete filled belltile filled with concrete set flush with the ground.

To reach: From the intersection of BLM Rd. 22-7-14 ( Big Tom Folley Crk. Rd.) and State Hwy #38 in T22S R7W sec. 14 proceed easterly along St. Hwy. #38 2.0 miles to monument on the right.

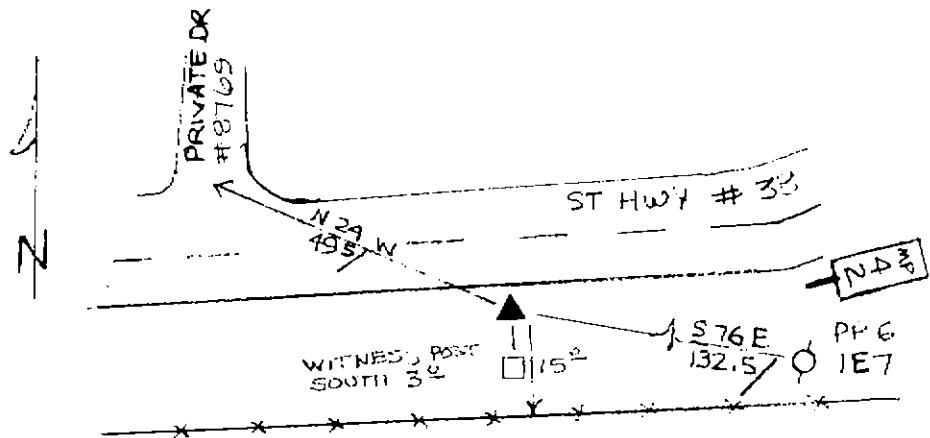

Note: For possible further information contact the Douglas County Surveyors Office, Room 205 Douglas County Justice Building, Roseburg, OR 97470. Phone 440-4272. Douglas County residents outside the Roseburg calling area, dial toll free 1-800-477-0991.