

OFFICE OF THE  
DOUGLAS COUNTY SURVEYOR

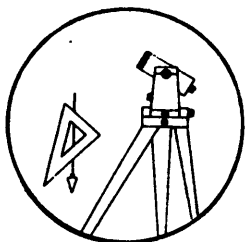

T-013

Station: T500 T 31 S, R 2 W, Sec 11  
 Set By (Agency): USC&GS  
 Date Set: 1949  
 Recovered By RS,SF  
 Date Recovered 1/18/84  
 Recovered By \_\_\_\_\_  
 Date Recovered \_\_\_\_\_  
 Recovered By \_\_\_\_\_  
 Date Recovered \_\_\_\_\_

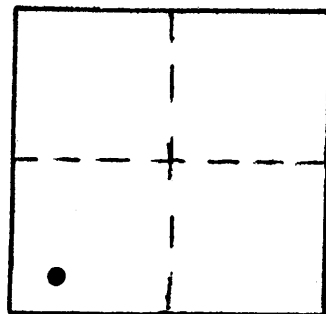

VERTICAL CONTROL NGVD 29

Elevation: 1298.888 NGS Line # 130 USGS Line # \_\_\_\_\_ OSHD Line # \_\_\_\_\_  
 Precision: 2nd Agency: USC&GS Proj. # \_\_\_\_\_ Date: 1957

HORIZONTAL CONTROL

South Zone State Plane Coordinates: Y(Northing) \_\_\_\_\_ X(Easting) \_\_\_\_\_  
 Precision: \_\_\_\_\_ Agency: \_\_\_\_\_ Proj. # \_\_\_\_\_ Date: \_\_\_\_\_  
 Approximate Geographic Position: Latitude \_\_\_\_\_ Longitude \_\_\_\_\_

DESCRIPTION and TO REACH

SKETCH

DESCRIPTION:

A USC&GS disk stamped "T500 1949" set flush in center of north bridge curb.

TO REACH:

From the intersection of State Hwy 227 and Tiller-South Umpqua Rd. (Co. Rd. #46) in T30S,R2W,Sec.33, proceed southeasterly along State Hwy. 227, 3.4 miles to monument on left.

From the intersection of State Hwy. 227 and Devils Knob Rd. (U.S.F.S. Rd. #301) in T31S,R2W,Sec.11, proceed westerly along State Hwy. 227, 0.2 miles to monument on right.

no good elev. on this disk

Reference Marks:

USC&GS DISK STAMPED "GAGING STATION" REFERENCE SET IN A 23'x12' CONCRETE BLOCK

GALVANIZED STEEL GAGING TOWER

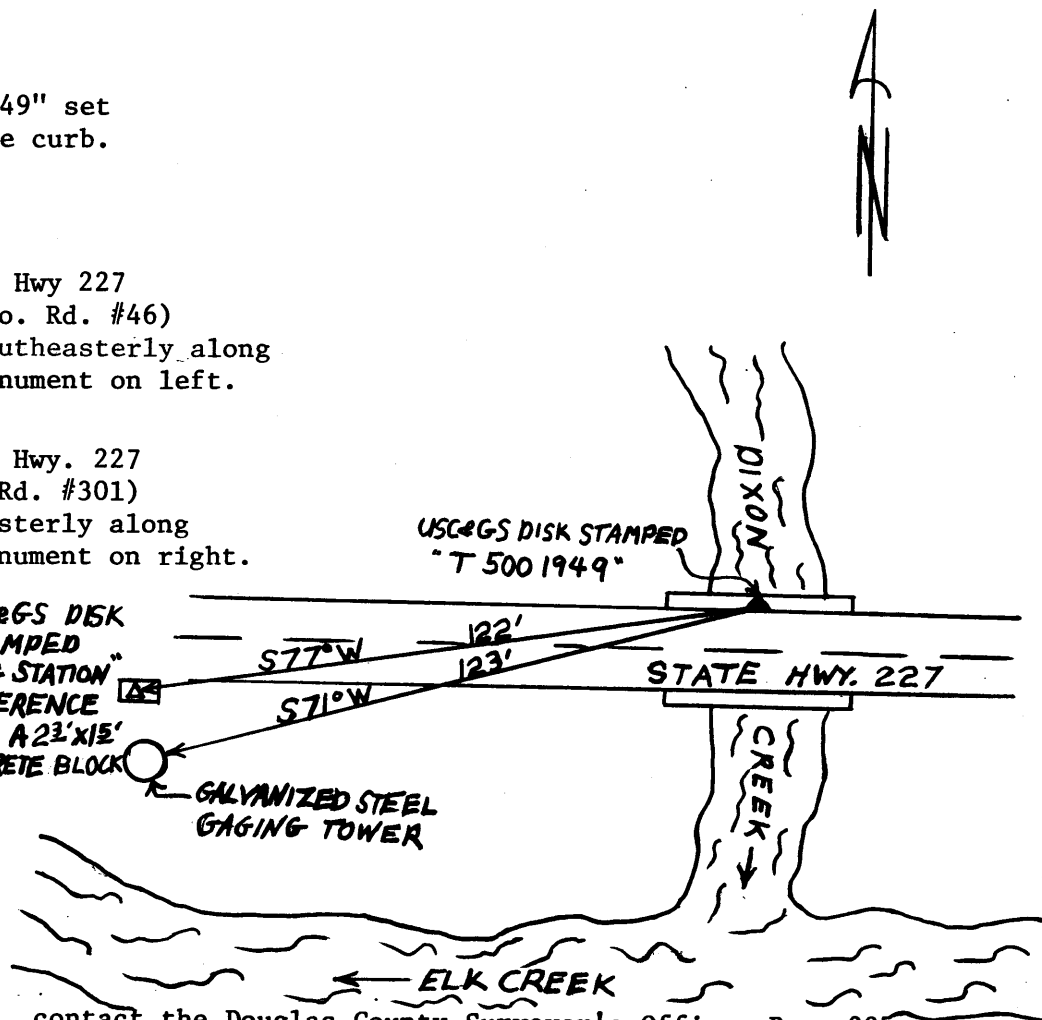

Note: For further information, contact the Douglas County Surveyor's Office, Room 205 Douglas County Justice Building, Roseburg, OR 97470. Phone 440-4278. Douglas County residents outside the Roseburg calling area, dial toll free 1-800-452-0991.