

OFFICE OF THE
DOUGLAS COUNTY SURVEYOR

Station: T 266
 Date Set: 1934
 Set By (Agency): ORGS
 DCSO Designation: T-007
 Date Recovered: JULY 1993
 Recovered By: RWS S.JF
 Date Recovered: _____
 Recovered By: _____
 Date Recovered: _____
 Recovered By: _____

T25S R5W Sec. 8

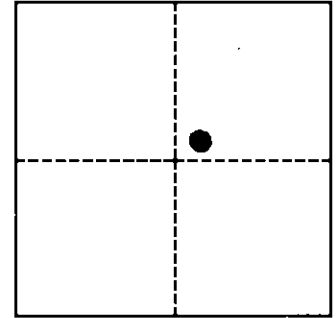
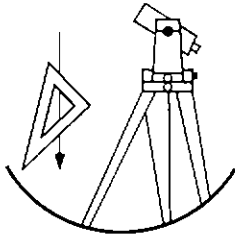

VERTICAL CONTROL

NGVD 29 Elevation: 494.130 FEET NAVD 88 Elevation: 151.682 METERS
 NGS Line # L25035 USGS LINE # _____ OSHD Line # _____ FILE # _____
 Precision: 1ST ORDER Agency: NGS Proj: _____ Date: 1988

HORIZONTAL CONTROL

O.C.S. 27 Y(Northing): _____ O.C.S. 83 Y(Northing): _____
 (South Zone) X(Easting): _____ (South Zone) X(Easting): _____
 Precision: _____ Agency: _____ Proj: _____ Date: _____
 Approx. O.C.S. 27 Geographic Position: Latitude: 43°24'40" Longitude: 123°18'45"
 Approx. O.C.S. 83 Geographic Position: Latitude: _____ Longitude: _____

Found: A 3 1/2 inch diameter Oregon Geodetic Survey disk stamped "T 266 1934" set flush in top near center of moss covered 3 X 5 foot boulder which protrudes approx. 1/2 foot above ground.

To reach: From the intersection of Oakland Underpass Rd. (Co. Rd. #10B) and Old Hwy 99 (Co. Rd. #388) proceed northerly along Old Hwy 99 approx. 0.10 miles to monument on left near railroad tracks.

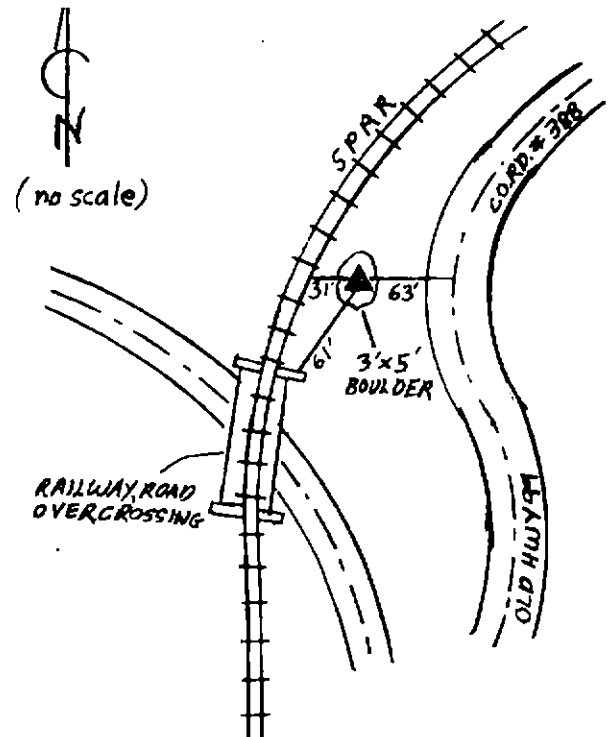

Note: For further information contact the Douglas County Surveyors Office, Room 205 Douglas County Justice Building, Roseburg, OR 97470. Phone 440-4272. Douglas County Residents outside Roseburg calling area, dial toll free 1-800-477-0991.