

OFFICE OF THE
DOUGLAS COUNTY SURVEYOR

Station: T9

T 28 S, R 6 W, Sec 33

Set By (Agency): USC&GS

Date Set: 1920

Recovered By RS, PB

Date Recovered 11/15/83

Recovered By _____

Date Recovered _____

Recovered By _____

Date Recovered _____

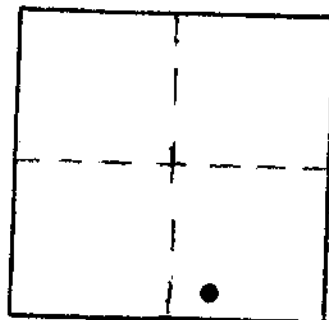

t-001
T 9

285 6W 33

NAD 530357.28 4144110.32
83 43° 5' 6" 123°24'36"

VERTICAL CONTROL **NGVD 29**

Elevation: 535.537 NGS Line # 6 USGS Line # _____ OSHD Line # _____

Precision: 1st Agency: USC&GS Proj. # _____ Date: 1957

HORIZONTAL CONTROL **OCS 27**

South Zone State Plane Coordinates: Y(Northing) 530,392.46 X(Easting) 1,223,152.06

Precision: 1/25,000 Agency: DCSO Proj. # 2013 Date: 1985

Approximate Geographic Position: Latitude 43°05'06" Longitude 123°24'31"

DESCRIPTION and TO REACH

SKETCH

DESCRIPTION:

A disk stamped "ELEV 534.815 FT 1920 T9"
set flush on a concrete headwall.

TO REACH:

From the intersection of Hwy. 99 and
Brockway Rd. (Co. Rd. #47) in T28S,
R6W, Sec. 32; proceed southeasterly
along Hwy. 99 1.35 miles to monument
on left.

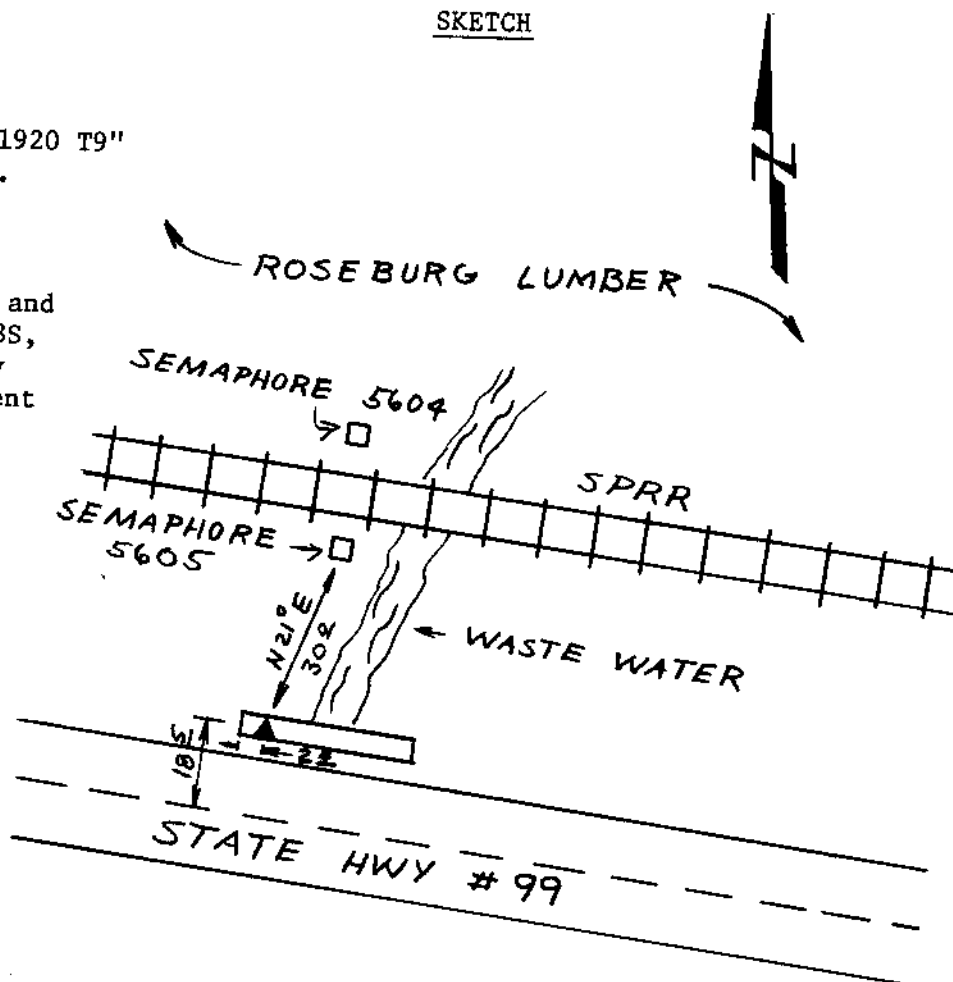

Reference Marks:

Note: For further information, contact the Douglas County Surveyor's Office, Room 205
Douglas County Justice Building, Roseburg, OR 97470. Phone 440-4278. Douglas
County residents outside the Roseburg calling area, dial toll free 1-800-452-0991.