

**DOUGLAS COUNTY SURVEYOR'S OFFICE**

Designation: S-211 Station: SOELK T 22S R 6W S 13 ¼ A

Date Set: NOV. 19, 2003 Set by (Agency): DCSO

Date Recovered: NOV. 19, 2003 Recovered by: SUF, JAP

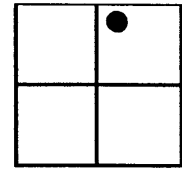

- Found       New       Reset  
 Not Found       Referenced       Destroyed

VERTICAL CONTROL

NGVD 29 Elevation: 315.20 Feet      File # CS 66/24  
 Precision: 3RD.      Agency: DCSO      Project: \_\_\_\_\_      Date: 9/04  
 NAVD 88 Elevation: \_\_\_\_\_ Meters      File # \_\_\_\_\_  
 Precision: \_\_\_\_\_      Agency: \_\_\_\_\_      Project: \_\_\_\_\_      Date: \_\_\_\_\_

HORIZONTAL CONTROL - south zone

N \_\_\_\_\_ E \_\_\_\_\_ Datum/Adj.: 1983      Precision: GIS  
 Lat: 43°39'46.6" Long: 123°21'20.3" Agency: DCSO      File # CS.66/24 Date: 6/06  
 N \_\_\_\_\_ E \_\_\_\_\_ Datum/Adj.: \_\_\_\_\_      Precision: \_\_\_\_\_  
 Lat: \_\_\_\_\_ Long: \_\_\_\_\_ Agency: \_\_\_\_\_      File # \_\_\_\_\_ Date: \_\_\_\_\_  
 N \_\_\_\_\_ E \_\_\_\_\_ Datum/Adj.: \_\_\_\_\_      Precision: \_\_\_\_\_  
 Lat: \_\_\_\_\_ Long: \_\_\_\_\_ Agency: \_\_\_\_\_      File # \_\_\_\_\_ Date: \_\_\_\_\_  
 N \_\_\_\_\_ E \_\_\_\_\_ Datum/Adj.: \_\_\_\_\_      Precision: \_\_\_\_\_  
 Lat: \_\_\_\_\_ Long: \_\_\_\_\_ Agency: \_\_\_\_\_      File # \_\_\_\_\_ Date: \_\_\_\_\_

DESCRIPTION AND TO REACH

A DCSO DISK STAMPED  
"SOELK 2003" SET FLUSH IN  
TOP OF 6" X 12" X 12" PROTRUDING  
PORTION OF A LARGE BURIED  
BOULDER. BOULDER IS NEAR TOP  
OF LONG ROADSIDE BERM.

FROM THE INTERSECTION OF  
HAYHURST RD. (CO. RD. #24) AND  
SOUTH ELK CREEK RD. (CO. RD. #197)  
IN T22S, R5W, SECTION 18 PROCEED  
WESTERLY ALONG SOUTH ELK CREEK  
RD. APPROXIMATELY 0.95 MILES TO  
MONUMENT ON RIGHT.

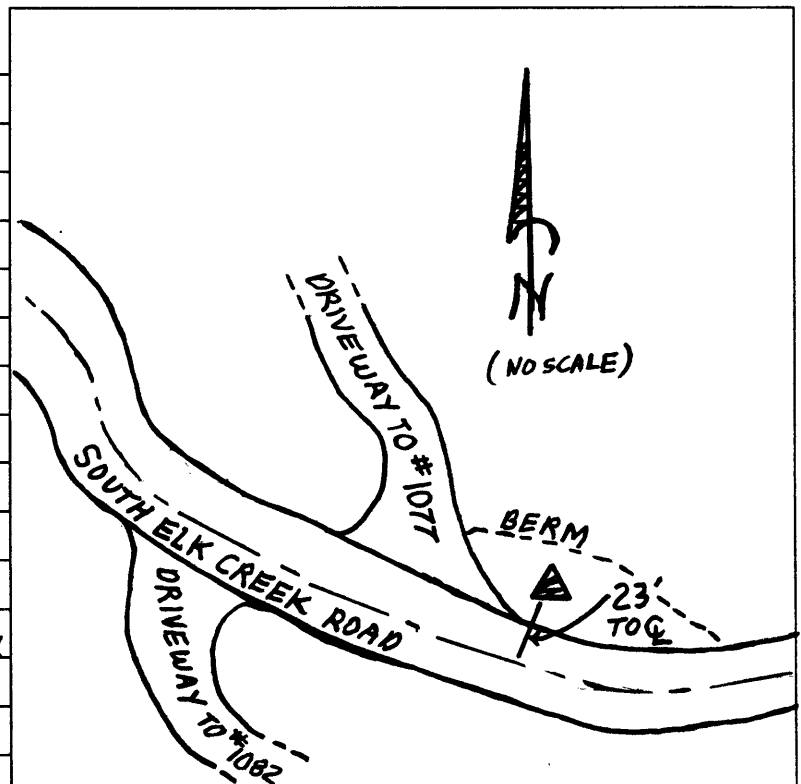



NARR  
ROAD

12. 5. 1999