

DOUGLAS COUNTY SURVEYOR'S OFFICE

100-1190

R102921B

Designation: S-209 Station: SMITH-7 T 21S R 11W S 16 1/4 NW

Date Set: 7- -03

Set by (Agency): DCSO

Date Recovered: 7- -03

Recovered by: STF JP

- Found
- New
- Reset
- Not Found
- Referenced
- Destroyed

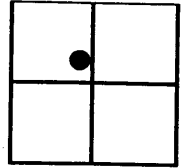

VERTICAL CONTROL

NGVD 29 Elevation: 22.71 Feet

File # CS67/05

Precision: 3rd

Agency: DCSO

Project: 2006

Date: 2003

NAVD 88 Elevation: _____ Meters

File # _____

Precision: _____

Agency: _____

Project: _____

Date: _____

HORIZONTAL CONTROL - south zone

N _____ E _____

Datum/Adj.: 1927

Precision: 615

Lat: 43° 44' 55.9" Long: 124° 00' 58.7"

Agency: DCSO

File # R102921B Date: 2003

N _____ E _____

Datum/Adj.: _____

Precision: _____

Lat: _____ Long: _____

Agency: _____

File # _____ Date: _____

N _____ E _____

Datum/Adj.: _____

Precision: _____

Lat: _____ Long: _____

Agency: _____

File # _____ Date: _____

N _____ E _____

Datum/Adj.: _____

Precision: _____

Lat: _____ Long: _____

Agency: _____

File # _____ Date: _____

DESCRIPTION AND TO REACH

DCSO DRILL CAMP STAMPED
"SMITH-7 2003 SET IN
CONCRETE CATTLE GUARD
FROM THE INTERSECTION OF
SOUTH SMITH RIVER RD. (CO. RD #195)
AND OTHER SLOUGH ROAD
(CO. RD #118) IN T21S R11W
SEC 20, PROCEED NORTHEASTERLY
ALONG SOUTH SMITH RIVER RD
1.75 MILE TO MONUMENT
ON LEFT AT NORTH
EAST CORNER OF CATTLE
GUARD ON GRACIE LN.

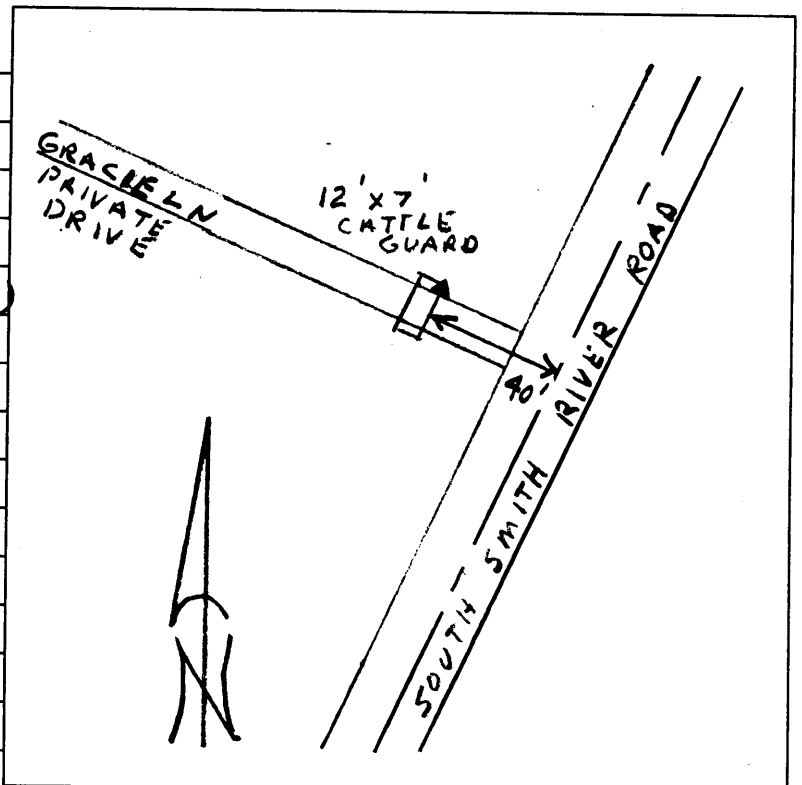



10.29.2003