

DOUGLAS COUNTY SURVEYOR'S OFFICE

NOT FINISHED #0750792
100-1179

R102921C
OFFSET WEST
90' TO MON.

Designation: S-2DS Station: SMITH-3 T 21S R 11W S 20 1/4 SW

Date Set: 7-22-03 Set by (Agency): DCSO

Date Recovered: 7-22-03 Recovered by: RWS STF

- Found
- New
- Reset
- Not Found
- Referenced
- Destroyed

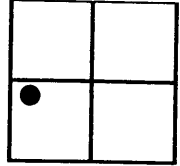

VERTICAL CONTROL

NGVD 29 Elevation: 10.56 Feet File # CS 671D5
 Precision: 3rd Agency: DCSO Project: 2006 Date: 2003
 NAVD 88 Elevation: _____ Meters File # _____
 Precision: _____ Agency: _____ Project: _____ Date: _____

HORIZONTAL CONTROL - south zone

N _____	E _____	Datum/Adj.: <u>1927</u>	Precision: <u>615</u>
Lat: <u>43°43'58.2"</u>	Long: <u>124°02'22.6"</u>	Agency: <u>DCSO</u>	File # <u>R102921C</u> Date: <u>2003</u>
N _____	E _____	Datum/Adj.: _____	Precision: _____
Lat: _____	Long: _____	Agency: _____	File # _____ Date: _____
N _____	E _____	Datum/Adj.: _____	Precision: _____
Lat: _____	Long: _____	Agency: _____	File # _____ Date: _____
N _____	E _____	Datum/Adj.: _____	Precision: _____
Lat: _____	Long: _____	Agency: _____	File # _____ Date: _____

DESCRIPTION AND TO REACH

DCSO DRILL CAP STAMPED
"SMITH-3 2003" SET IN 3'X2'
PIECE OF EXPOSED SAND STONE
LEVEL WITH ROAD SURFACE

FROM THE INTERSECTION OF
SMITH RIVER ROAD (CO. RD #48)
AND SOUTH SMITH RIVER RD (CO. RD
#125) IN T21S R11W SEC 12
PROCEED SOUTH EASTERLY
ALONG SOUTH SMITH RIVER RD.
1.70 MILES TO MONUMENT
ON RIGHT.

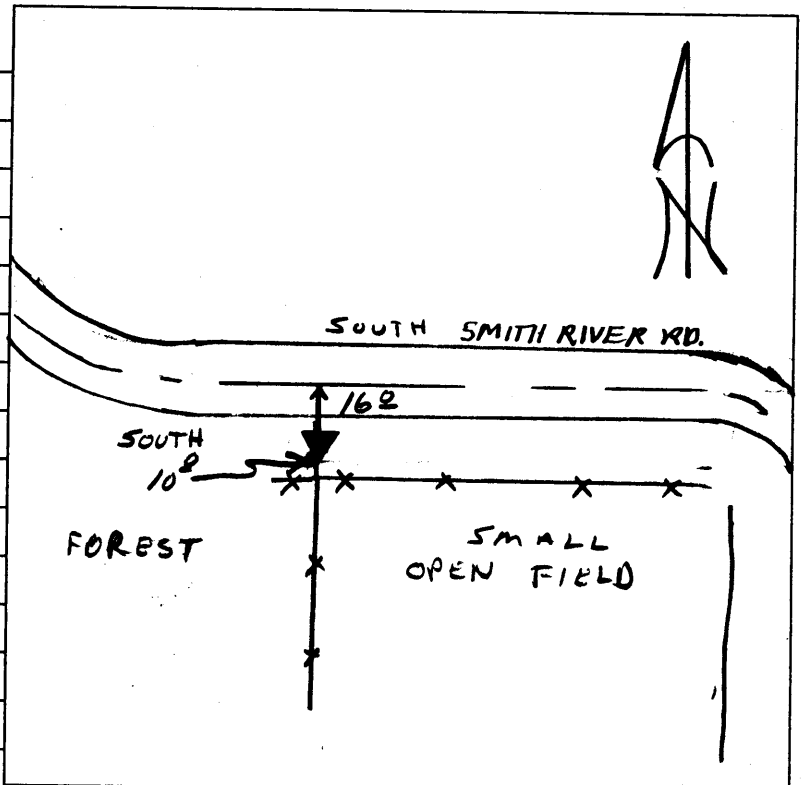



7.30.2003