

Station: SCR-3  
 Date Set: JULY, 1998  
 Set By (Agency): DCSO  
 Date Recovered: 7/27/98  
 Recovered By: \_\_\_\_\_

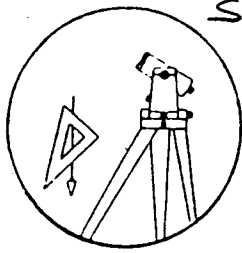

S-180

- |                                     |   |
|-------------------------------------|---|
| <input type="checkbox"/> Found      | <input checked="" type="checkbox"/> New |
| <input type="checkbox"/> Reset      | <input type="checkbox"/> Not Found      |
| <input type="checkbox"/> Referenced | <input type="checkbox"/> Destroyed      |

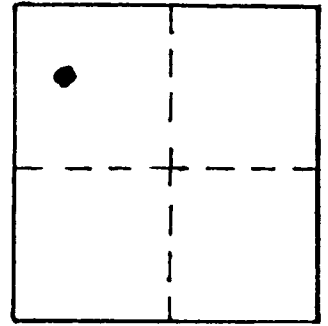

VERTICAL CONTROL

Elevation: 637.94 NGS Line # \_\_\_\_\_ USGS Line # \_\_\_\_\_ OSHD Line # \_\_\_\_\_  
 Precision: 3rd Agency: DCSO Proj. # 2007 Date: 1998

HORIZONTAL CONTROL CORPSCOMB NAVD88 641.39 FT. CS 66/49

South Zone O.C.S. 27: Y(Northing) \_\_\_\_\_ X(Easting) \_\_\_\_\_

South Zone O.C.S. 83: Y(Northing) 545882 X(Easting) 4120571

Precision: GIS SCALED Agency: DCSO Proj. # \_\_\_\_\_ Date: 2014

Approx. NAD <sup>83</sup> Geographic Position: Latitude 43° 07' 31" Longitude 123° 29' 55"

DESCRIPTION and TO REACH

A DCSO DRILL CAP STAMPED "SCR-3 1998" SET FLUSH ON ROCK LEDGE NEAR EASTERLY END OF ROCK BLUFF CUT-BANK.

FROM THE INTERSECTION OF STATE HIGHWAY 42 AND STRICKLAND CANYON ROAD (Co. Rd. #108) IN T28S, R7W, SEC27 PROCEED EASTERLY AND NORTHERLY ALONG STRICKLAND CANYON ROAD APPROXIMATELY 1.65 MILES TO MONUMENT ON LEFT.

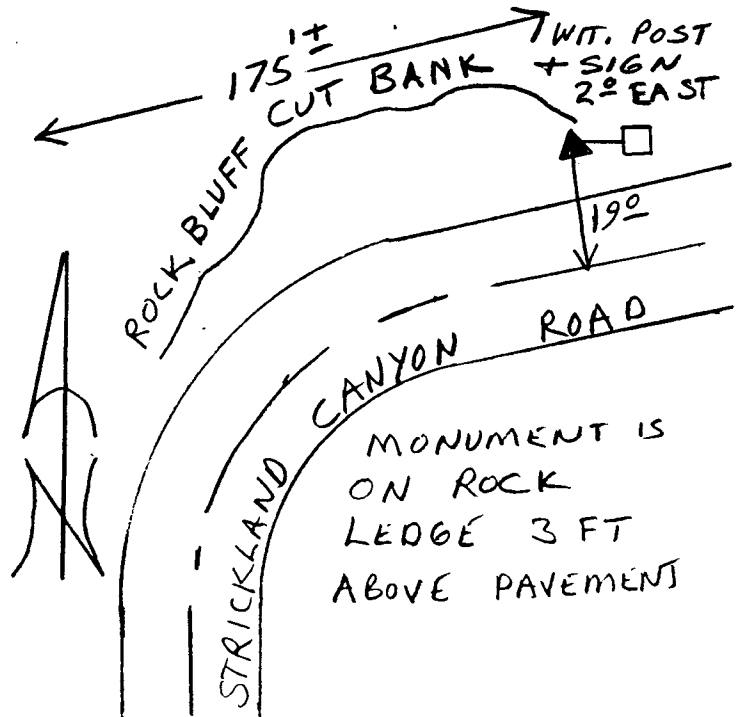

Reference Marks: