

OFFICE OF THE
DOUGLAS COUNTY SURVEYOR

Station: SANDERS

T27W R5W Sec. 35

Date Set: 1994

Set By (Agency): DCSO

DCSO Designation: S-176

Date Recovered: 4-94

Recovered By: RWS SJF

Date Recovered: 1-03

Recovered By: RWS, SJF

Date Recovered: _____

Recovered By: _____

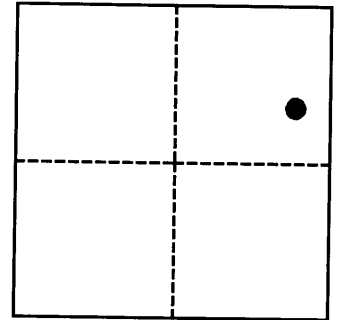
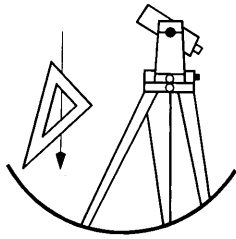

VERTICAL CONTROL

NGVD 29 Elevation: 661.70 ~~661.61~~ FEET NAVD 88 Elevation: _____ METERS

NGS Line # _____ USGS LINE # _____ OSHD Line # _____ FILE # _____

Precision: 3RD ORDER Agency: DCSO PLS 1941 Proj: CS 66/63 ~~1994-0033~~ Date: 2003 ~~4-1994~~

HORIZONTAL CONTROL

O.C.S. 27 Y(Northing): _____ O.C.S. 83 Y(Northing): _____

(South Zone) X(Easting): _____ (South Zone) X(Easting): _____

Precision: GIS Agency: DCSO Proj: CS 66/63 R012217B Date: 2003

Approx. O.C.S. 27 Geographic Position: Latitude: 43° 10' 54.1" Longitude: 123° 14' 51.5"

Approx. O.C.S. 83 Geographic Position: Latitude: _____ Longitude: _____

Found: A 2 inch diameter brass disk stamped "SANDERS 1994 PLS 1941" set in top of 8 inch diameter, 36 inch long concrete monument, firmly set in soil and protruding approx. 4 inch.

To reach: From the intersection of Buckhorn Rd. (Co. Rd. #17) and Dixonville Rd. (Co. Rd. #16E) in T27S R5W Sec. 24 proceed southerly along Dixonville Rd. approx. 1.9 miles to monument on right.

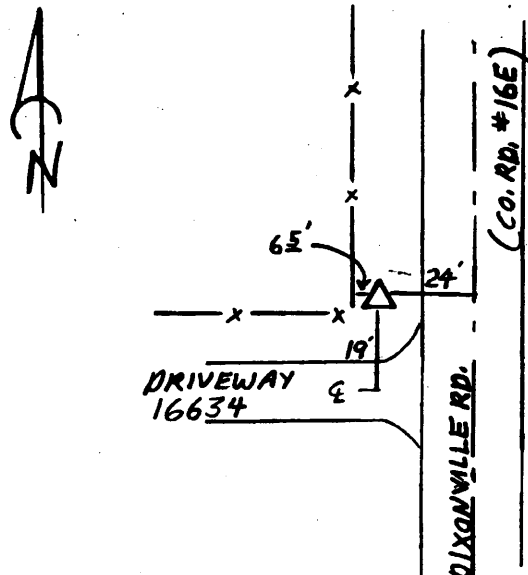

Note: For further information contact the Douglas County Surveyors Office, Room 205 Douglas County Justice Building, Roseburg, OR 97470. Phone 440-4272. Douglas County Residents outside Roseburg calling area, dial toll free 1-800-477-0991.