

OFFICE OF THE  
DOUGLAS COUNTY SURVEYOR

Station: SM 1 RM 1

T 29 S, R 5W , Sec 27

Date Set: 1978

Set By (Agency): DCSO

Date Recovered: 11/91

Recovered By: Ruppert LS 866

Date Recovered: \_\_\_\_\_

Recovered By: \_\_\_\_\_

Date Recovered: \_\_\_\_\_

Recovered By: \_\_\_\_\_

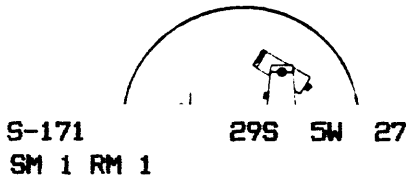
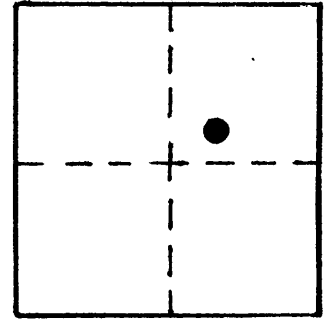

NAD 506610.96 4179602.94  
83 43° 1' 23" 123° 16' 27"

VERTICAL CONTROL NGVD 29

Elevation: ~~652.1~~ 651.93 NGS Line # \_\_\_\_\_ USGS Line # \_\_\_\_\_ OSHD Line # \_\_\_\_\_

Precision: GPS 3rd Agency: DCSO Proj. # 2017-1 CS64/22 Date: 1991 1992

HORIZONTAL CONTROL

South Zone O.C.S. 27: Y(Northing) 506,646.38 X(Easting) 1,258,644.80

South Zone O.C.S. 83: Y(Northing) \_\_\_\_\_ X(Easting) \_\_\_\_\_

Precision: 1/15,000 Agency: DCSO Proj. # 2017-1 CS64/22 Date: 1991

Approx. NAD 83 Geographic Position: Latitude 43° 01' 24" Longitude 123° 16' 23"

DESCRIPTION and TO REACH

Found: A standard DCSO disk stamped "SM 1 RM 1 1978" set in a concrete curb.

To Reach: Mon. is 200 ft. northerly from the intersection of Neal Ln. and Riverside Dr. in Myrtle Creek.

SKETCH

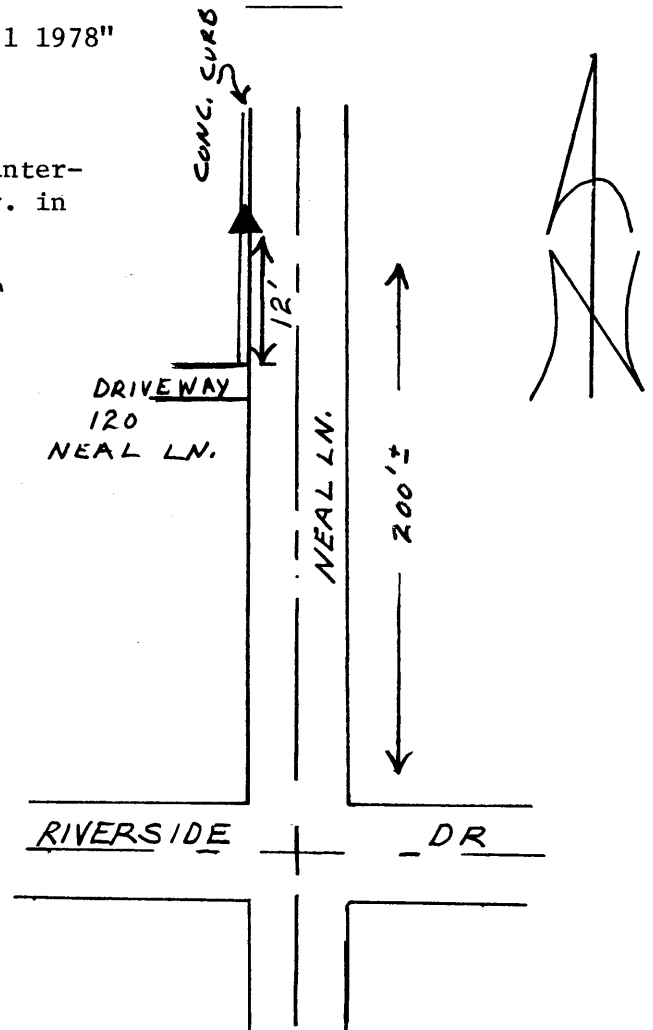

Reference Marks:

Note: For further information, contact the Douglas County Surveyor's Office, Room 205 Douglas County Justice Building, Roseburg, OR 97470. Phone 440-4278. Douglas County residents outside the Roseburg calling area, dial toll free 1-800-452-0991.