

OFFICE OF THE
DOUGLAS COUNTY SURVEYOR

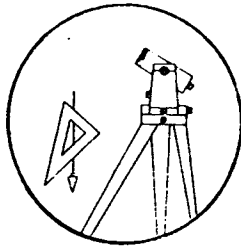

DESIG. S-161

Station: SUZY. T 25 S, R 4 W, Sec 7
 Set By (Agency): DCSO
 Date Set: 1989
 Recovered By RWS, SJF
 Date Recovered 5/8/89
 Recovered By _____
 Date Recovered _____
 Recovered By _____
 Date Recovered _____

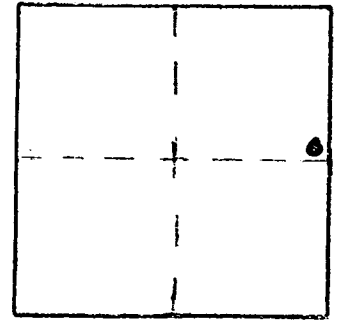

VERTICAL CONTROL NGVD 29

Elevation: 628.14 NGS Line # _____ USGS Line # _____ OSHD Line # _____
 Precision: 3rd Agency: DCSO Proj. # 2007 Date: 1990

HORIZONTAL CONTROL CORPSCON 6 NAVD 88 631.68 FT.

South Zone State Plane Coordinates: Y(Northing) 647271 X(Easting) 4201859
 Precision: GIS SCALED Agency: DCSO Proj. # _____ Date: 2014
 Approximate Geographic Position: Latitude _____ Longitude _____

DESCRIPTION and TO REACH

A DCSO disk stamped "SUZY 1989" set in a 8 in. dia. by 40 in. long concrete filled belltile protruding 4 in. above ground.

Go to the intersection of Nonpareil Rd. (Co.Rd.#19) and FairOaks Rd. (Co.Rd.#22A), in T25S,R4W,Sec. 7 monument lies in triangle of intersecting roads.

SKETCH

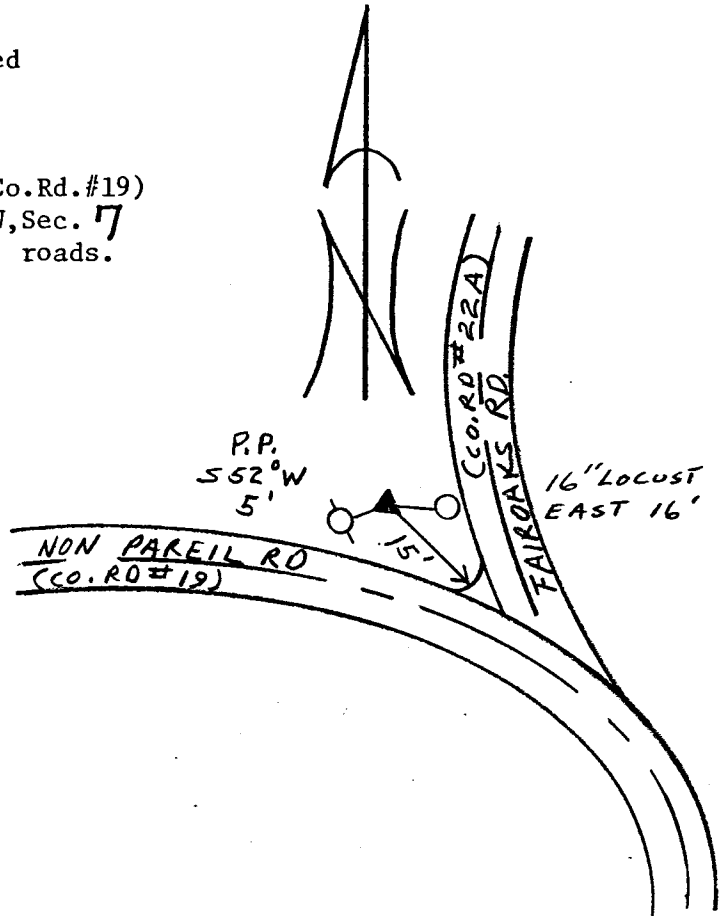

Reference Marks:

Note: For further information, contact the Douglas County Surveyor's Office, Room 205 Douglas County Justice Building, Roseburg, OR 97470. Phone 440-4278. Douglas County residents outside the Roseburg calling area, dial toll free 1-800-452-0991.