

Set By (Agency): DCSO

Date Set: 3-4-85

Recovered By _____

Date Recovered _____

Recovered By _____

Date Recovered _____

Recovered By _____

Date Recovered _____

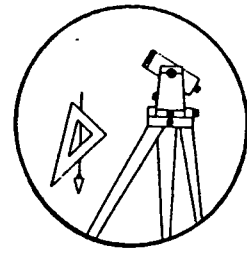
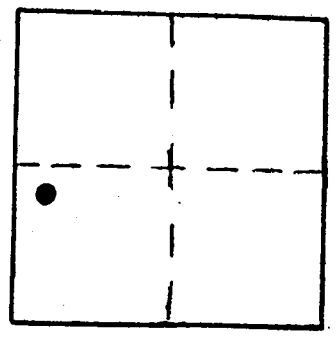

Destroyed

REPLACED
BY SWAN RESET
(S-216)

S-152

VERTICAL CONTROL NGVD 29

Elevation: 545.648 ft. NGS Line # _____ USGS Line # _____ OSHD Line # _____

Precision: 2nd Agency: DCSO Proj. # 2013 Date: 1985

HORIZONTAL CONTROL CORPSCON6 NAVD88 549.085 FT. CS 66161

South Zone State Plane Coordinates: Y(Northing) 548652 X(Easting) 4131053

Precision: GIS SCALED Agency: DCSO Proj. # _____ Date: 2014

Approximate Geographic Position: Latitude 43°08'01" Longitude 123°27'35"

DESCRIPTION and TO REACH

SKETCH

DESCRIPTION:

A DCSO brass cap set in wingwall at the northwest corner of bridge over Lookingglass Creek stamped "SWAN 1985."

TO REACH:

From the intersection of Lookingglass Rd. (Co. Rd. #47) and Happy Valley Rd. (Co. Rd. #26) in T28S, R6W, Sec. 7, proceed southerly along Lookingglass Rd. 1.0 miles to monument on right.

Reference Marks:

A DCSO disk stamped "SWAN RM1 1985" bears S30°E, 315± ft. (geod.), elev. 548.714 ft.

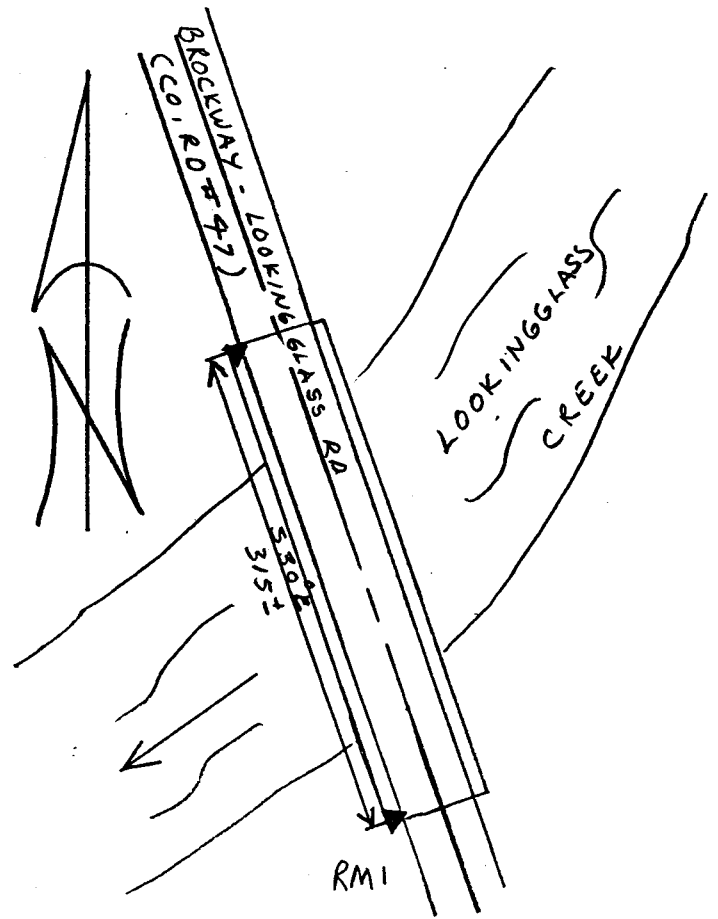

Note: For further information, contact the Douglas County Surveyor's Office, Room 205 Douglas County Justice Building, Roseburg, OR 97470. Phone 440-4278. Douglas County residents outside the Roseburg calling area, dial toll free 1-800-452-0991.

Destroyed per ic engineering see S-216 for Swan Reset