

OFFICE OF THE  
DOUGLAS COUNTY SURVEYOR

Station: SURVEY T 27 S, R 1 W, Sec 7

Set By (Agency): DCSO

Date Set: 1981

Recovered By \_\_\_\_\_

Date Recovered \_\_\_\_\_

Recovered By \_\_\_\_\_

Date Recovered \_\_\_\_\_

Recovered By \_\_\_\_\_

Date Recovered \_\_\_\_\_

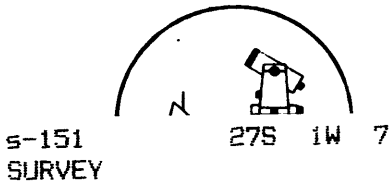
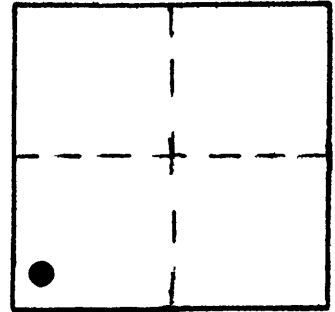

NAD 578796.84 4289761.18  
83 43°13'49" 122°52'12"

VERTICAL CONTROL

Elevation: \_\_\_\_\_ NGS Line # \_\_\_\_\_ USGS Line # \_\_\_\_\_ OSHD Line # \_\_\_\_\_

Precision: \_\_\_\_\_ Agency: \_\_\_\_\_ Proj. # \_\_\_\_\_ Date: \_\_\_\_\_

HORIZONTAL CONTROL **NAD 27**

South Zone State Plane Coordinates: Y(Northing) 578,833.43 X(Easting) 1,368,801.48

Precision: 1/25,000 Agency: DCSO Proj. # 2004-23 CS 61/35 Date: 1982

Approximate Geographic Position: Latitude 43° 13' 50" Longitude 122° 52' 08"

DESCRIPTION and TO REACH

Station is a standard DCSO disk stamped "SURVEY 1981". The cap is set in a 6"x40" concrete belltile filled with concrete and buried 35' deep.

To Reach: From the intersection of St. Hwy 138 and Co. Rd. 17 (Little River Rd.) west of Glide, proceed Southerly and Easterly along Co. Rd. 17 (it becomes FS 272) past Peel, Wolf Cr. Job Corps, and Emile Cr.. Continue on FS 272 past its intersection with FS 2703 to the Coolwater Campground and the station on left.

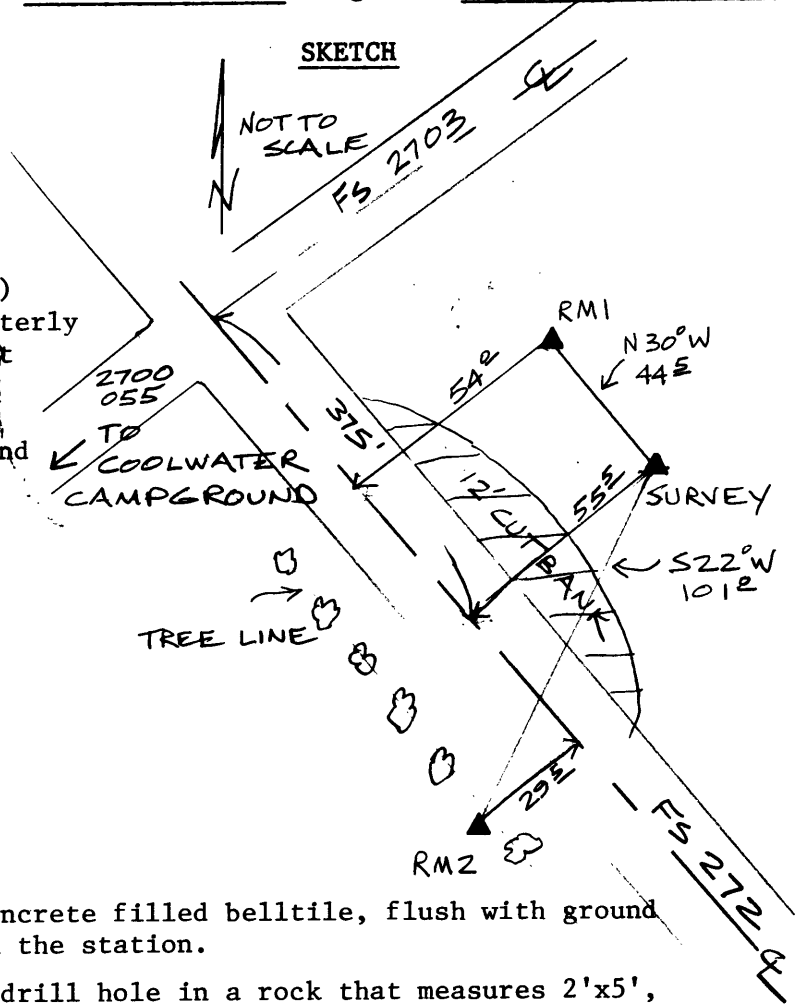

Reference Marks:

"SURVEY RM1 1981", a DCSO disk set in concrete filled belltile, flush with ground bears N33°14'12"W 44.68 ft (grid) from the station.

"SURVEY RM2 1981", a DCSO disk set in a drill hole in a rock that measures 2'x5', and 2 ft. higher than the asphalt, bears S26°12'53"W 100.76 ft. (grid) from the station.

Note: For further information, contact the Douglas County Surveyor's Office, Room 205 Douglas County Justice Building, Roseburg, OR 97470. Phone 440-4278. Douglas County residents outside the Roseburg calling area, dial toll free 1-800-452-0991.