

OFFICE OF THE
DOUGLAS COUNTY SURVEYOR

Station: SUN T 26 S, R 5 W, Sec 26

Set By (Agency): DCSO

Date Set: 1972

Recovered By RWS, SJF

Date Recovered 3/12/86

Recovered By RWS/SJF

Date Recovered 5/16/01

Recovered By _____

Date Recovered _____

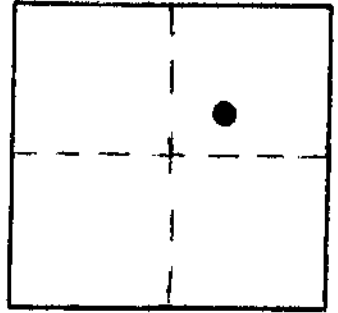

s-150
SUN

26S 5W 26

NAD 600786.21 4188651.51
83 43°16'56" 123°15' 7"

VERTICAL CONTROL NGVD 29

Elevation: 599.36 NGS Line # _____ USGS Line # _____ OSHD Line # _____

Precision: 3rd Agency: DCSO Proj. # _____ Date: 2001

HORIZONTAL CONTROL OCS 27

South Zone State Plane Coordinates: Y(Northing) 600,821.42 X(Easting) 1,267,692.46

Precision: 1/25,000 Agency: DCSO Proj. # 2006 Date: 1972

Approximate Geographic Position: Latitude 43°16'56" Longitude 123°15'02"

DESCRIPTION and TO REACH

SKETCH

A DCSO disk stamped "SUN 1972" set in a 6 in. dia. concrete filled belltile protruding 6 in. above ground.

From the intersection of Sunshine Rd. (Co. Rd.#58) and North Umpqua Hwy. (State Hwy. #138) in T27S,R5W,Sec.15 proceed northerly along Sunshine Rd. 4.9 miles to its intersection with Still Water Rd. and monument on left.

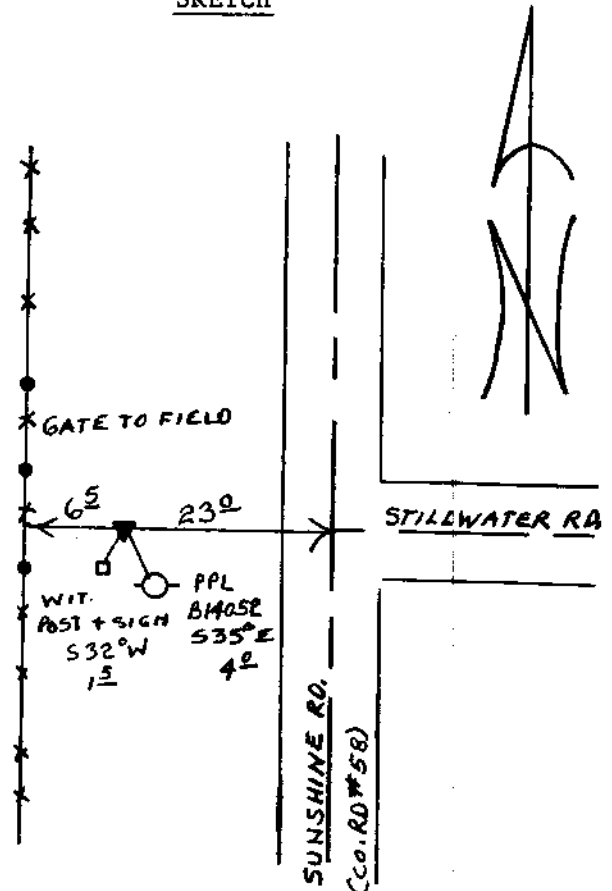

Reference Marks:

Note: For further information, contact the Douglas County Surveyor's Office, Room 205 Douglas County Justice Building, Roseburg, OR 97470. Phone 440-4278. Douglas County residents outside the Roseburg calling area, dial toll free 1-800-452-0991.