

OFFICE OF THE
DOUGLAS COUNTY SURVEYOR

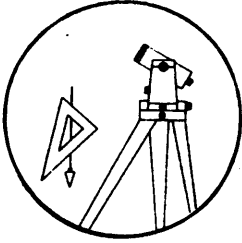

S-139

Station: Stout T 30 S, R 6W , Sec 27
 Set By (Agency): PRIVATE
 Date Set: 1981
 Recovered By LEM
 Date Recovered 2-82
 Recovered By _____
 Date Recovered _____
 Recovered By _____
 Date Recovered _____

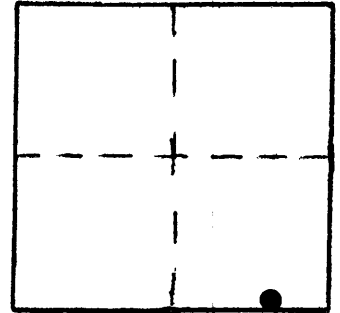

VERTICAL CONTROL NGVD 29

Elevation: 690.39 NGS Line # _____ USGS Line # _____ OSHD Line # _____
 Precision: 3rd Agency: LS#1261 Proj. # MLP M87-58 Date: 1981

HORIZONTAL CONTROL

South Zone State Plane Coordinates: Y(Northing) _____ X(Easting) _____
 Precision: _____ Agency: _____ Proj. # _____ Date: _____
 Approximate Geographic Position: Latitude _____ Longitude _____

DESCRIPTION and TO REACH

SKETCH

Found: Station mark is a brass disk stamped "Stout 1981 Elevation 690.39 RPLS 1261". Station is set in a 8" concrete post protruding 4 1/2" above ground, approx. 3ft. below the road surface.

To reach: From the intersection of Co. Rd. #39 (Glenbrook Loop) and Co. Rd. #44 (Shoestring Road) in T30S R6W sec. 26, proceed westerly along Co. Rd. #39 0.4 miles to the monument on the right.

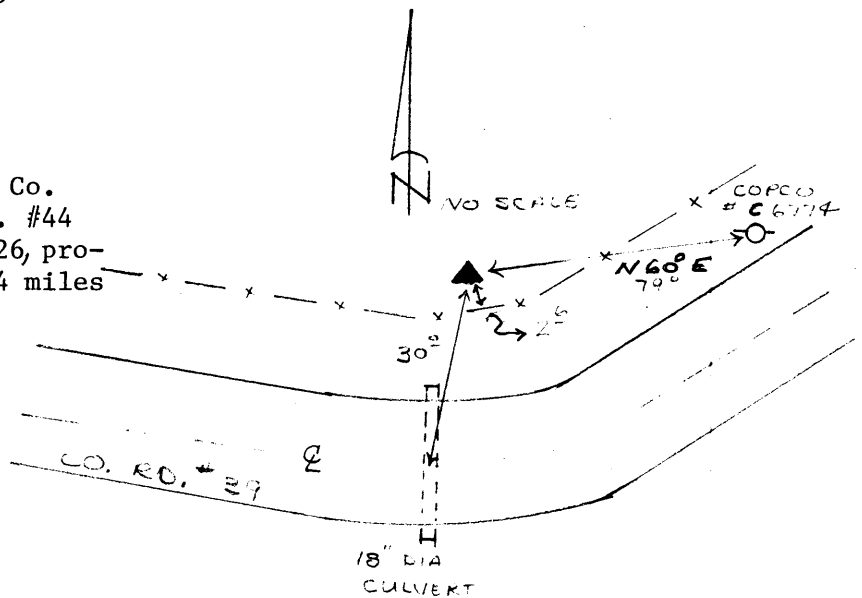

Reference Marks:

Note: For further information, contact the Douglas County Surveyor's Office, Room 205 Douglas County Justice Building, Roseburg, OR 97470. Phone 440-4278. Douglas County residents outside the Roseburg calling area, dial toll free 1-800-452-0991.