

OFFICE OF THE
DOUGLAS COUNTY SURVEYOR

Station: STEPH-9 RESET T 29 S, R 5 W, Sec 28

Set By (Agency): D.C.S.O.

Date Set: 1979 - 1986

Recovered By RS, SJF

Date Recovered June 7, 1984

Recovered By RWS, SJF

Date Recovered 8/6/86

Recovered By _____

Date Recovered _____

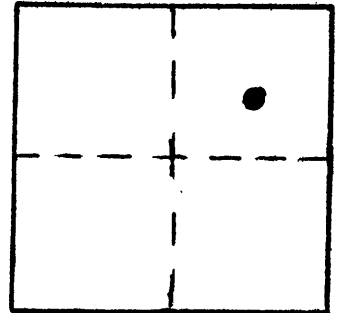

s-134 29S 5W 28
STEPH-9 RESET

NAD 507302.30 4175755.06
83 43° 1'29" 123°17'19"

VERTICAL CONTROL

Elevation: _____ NGS Line # _____ USGS Line # _____ OSHD Line # _____

Precision: _____ Agency: _____ Proj. # _____ Date: _____

HORIZONTAL CONTROL **OCS 27**

South Zone State Plane Coordinates: Y(Northing) 507,337.88 X(Easting) 1,254,796.60

Precision: 1/25,000 Agency: D.C.S.O. Proj. # 2004-16 C.S.61/1 Date: 1979

Approximate Geographic Position: Latitude 43°01'29" Longitude 123°17'15"

DESCRIPTION and TO REACH

SKETCH

A boatspike stamped "STEPH 9 R"
set flush in asphalt.

TO REACH:

From the intersection of Main Street
(State Highway 99) and First Avenue in
Myrtle Creek, Oregon T29S, R5W, Sec. 28,
proceed southeasterly along Main Street
approximately 100 feet to monument on left.

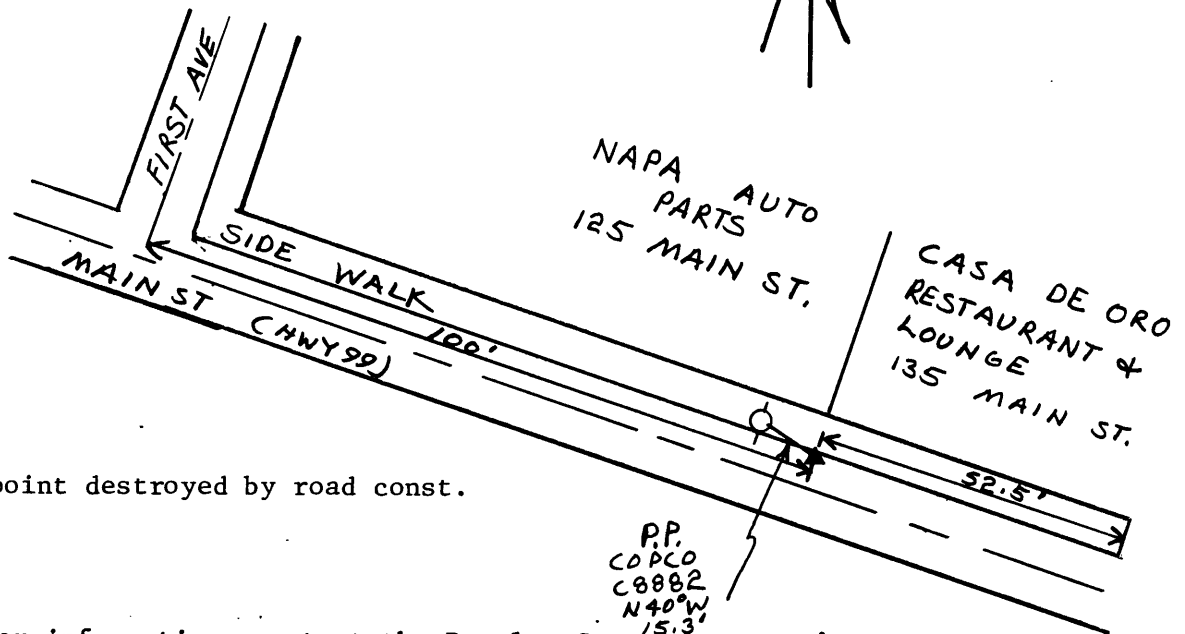

Reference Marks:

Note: original point destroyed by road const.

Note: For further information, contact the Douglas County Surveyor's Office, Room 205 Douglas County Justice Building, Roseburg, OR 97470. Phone 440-4278. Douglas County residents outside the Roseburg calling area, dial toll free 1-800-452-0991.