

OFFICE OF THE
DOUGLAS COUNTY SURVEYOR

Station: SON
 Set By (Agency): SCS
 Date Set: 1975
 Recovered By RWS, SJE
 Date Recovered 3/6/87
 Recovered By _____
 Date Recovered _____
 Recovered By _____
 Date Recovered _____

T 25 S, R 4 W, Sec 3

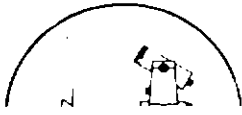
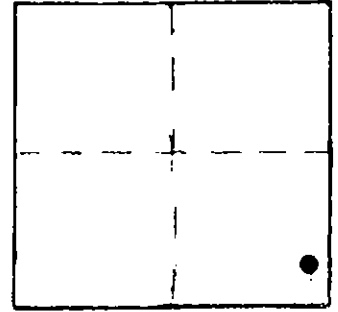

s-114
SON

255 4W 3

480 650019.88 4817602.29
 62 43°25'11" 123°08'52"

VERTICAL CONTROL

Elevation: 813.776 NGS Line # _____ USGS Line # _____ OSHD Line # _____
 Precision: 2nd Agency: DCSO Proj. # 6011-1CS57/25 Date: 1975

HORIZONTAL CONTROL

South Zone State Plane Coordinates: Y(Northing) 650,054.65 X(Easting) 1,296,641.98
 Precision: 1/25,000 Agency: DCSO Proj. # 6011-1 CS57/25 Date: 1975
 Approximate Geographic Position: Latitude 43°25'12" Longitude 123°08'52"

DESCRIPTION and TO REACH

An SCS 2 1/2 in. dia. disk stamped "SON SCS" set in an 8 in. dia. concrete filled belltile protruding 15 in. above ground.

TO REACH;

From the intersection of Thomas Rd. (Co. Rd. #268) and Nonpariel Rd. (Co. Rd. #19) in T25S, R4W, Sec.10. proceed northeasterly along Nonpariel Rd. approximately 1.1 miles to monument RP 265+49.88 on right. (see DCSO monument station sheet) Monument SON bears approx. N 36° E. 585 ft. Monument is near small grove of oak trees on first hill north of road.

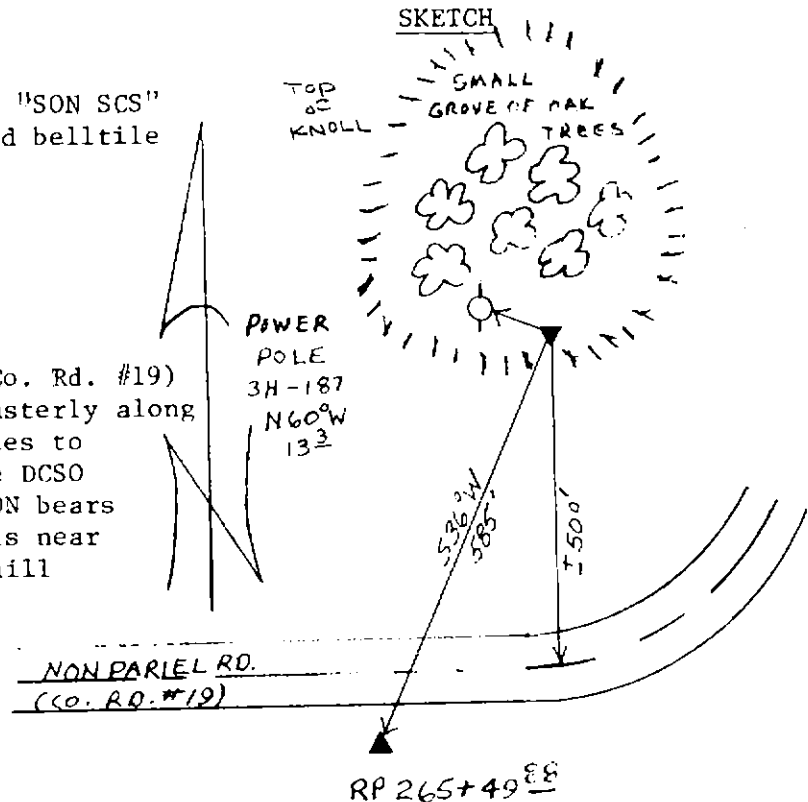

Reference Marks:

Note: For further information, contact the Douglas County Surveyor's Office, Room 205 Douglas County Justice Building, Roseburg, OR 97470. Phone 440-4278. Douglas County residents outside the Roseburg calling area, dial toll free 1-800-452-0991.